

## Maxi-Opener Lantern

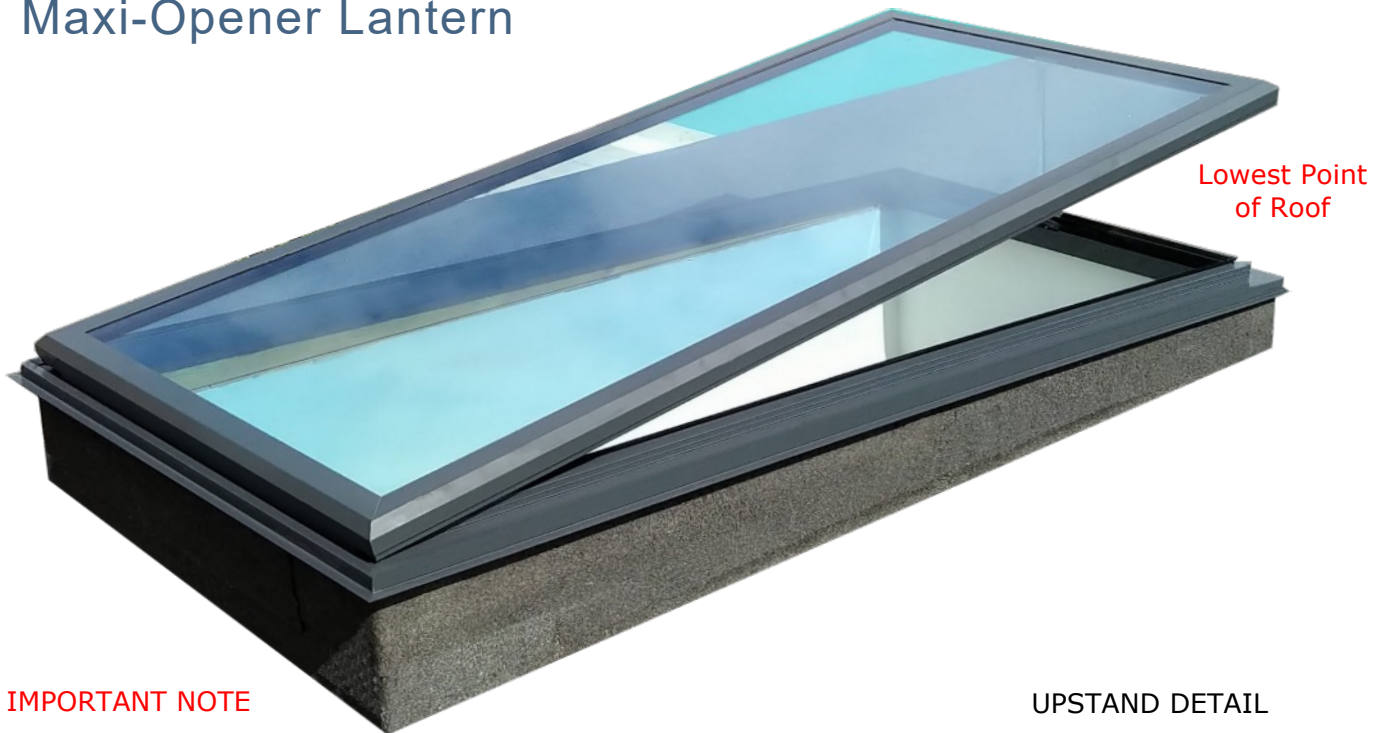

### IMPORTANT NOTE

#### FALL

Upstand must have a minimum of a 5 degree fall from front to back. DO NOT PROCEED IF NOT. A five degree slope is approximately 100mm of fall for every 1m of depth.

#### FLAT

Check upstand top is even and flat ie vent frame must not bow when screwed down.

#### MOTOR CLEARANCE

Upstand must not be more than 80mm wide so as not to touch motor housing. Motor must be able to pivot once screwed down.

### UPSTAND DETAIL

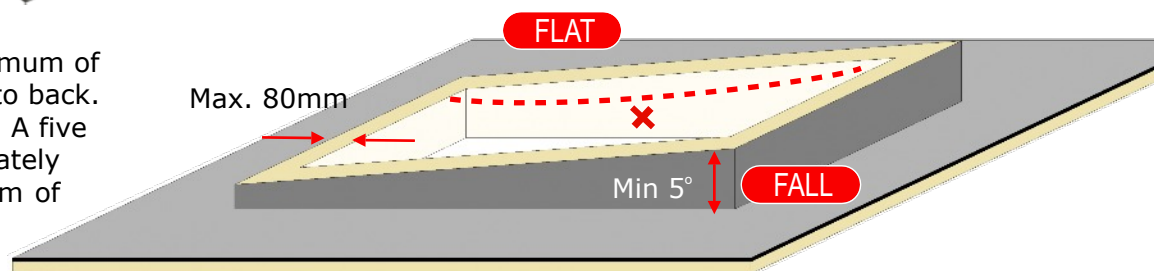

### IMPORTANT NOTE

Motor must be able to pivot freely

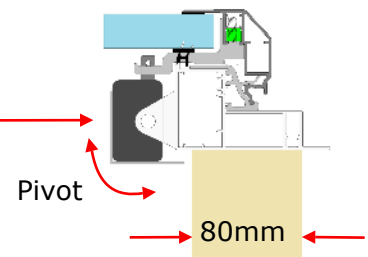

Max. upstand width is 80mm. If your upstand is deeper than 80mm we can supply an upstand packer.

### REMOVING VENT LID FROM VENT FRAME.



Remove the vent lid from the vent frame prior to installing. To do this first remove the grenade pin from the motor then lift the vent lid to 45 degree until it disengages from the frame.





Check opening is the correct size.



Lay an even bed of sealant around the upstand.



With the lid removed (see front page) bed down frame.



Insert 80mm screws into rubber fixing points on frame.

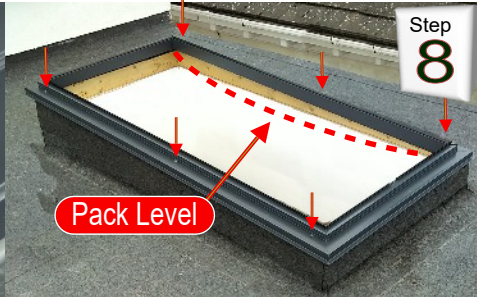

Secure frame. DO NOT BOW FRAME by over tightening.

## Glazing the vent lid

Begin by laying the vent lid on a flat surface - the fitted frame is ideal for this.

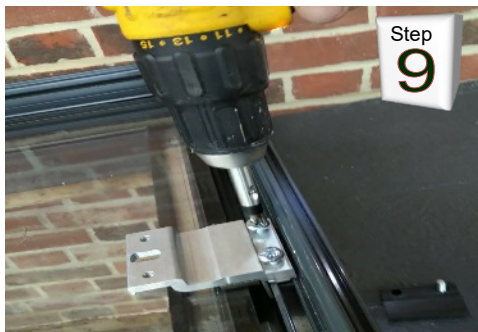

Remove motor arm from lid prior to glazing.



Peel off the protective paper on glazing seals.



Glaze glass unit up the correct way, see glass label.



Pack glass unit evenly with glazing packers.



Screw motor arm back onto lid.

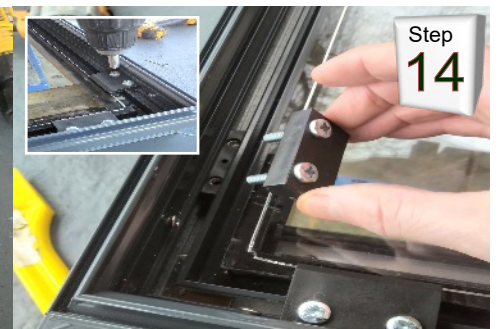

Screw glass clamps to receiver blocks, positioned around frame.

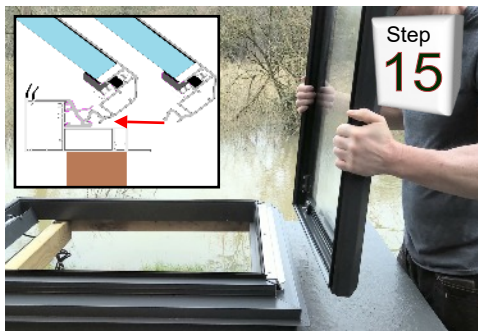

Once lid is glazed, flip over and fit back on the vent frame.

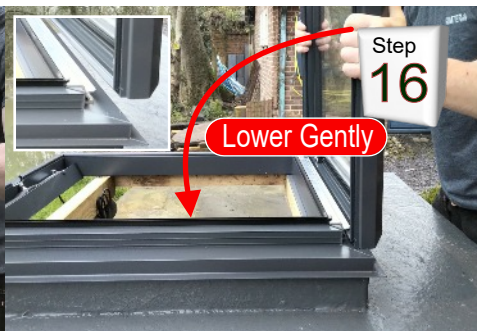

Locate lid in hinge bar and GENTLY lower lid down, stop if you feel resistance, lift lid and start again.



Finally replace grenade pin to reconnect the motor to the lid motor arm.