

Lacron Sureflow TMV Top Mount Filters with MPV



Prices are for Filter, MPV & Pressure Gauge only.

Filter Sand & Pea Gravel is purchased separately.

Refer to page 198 for filter media.

Code	Description	Media Required	Price
1.5" Connections:			
TMV18	18" dia. (450mm) Tank c/w 1.5"MPV	75kg	485.00
TMV24	24" dia. (610mm) Tank c/w 1.5"MPV	125kg	679.00

Lacron Sureflow LSR Filters c/w Side Mount MPV & PG



Prices are for Filter, MPV & Pressure Gauge only.

Filter Sand & Pea Gravel is purchased separately.

Refer to page 198 for filter media

Code	Description	Media Required	Price
1.5" Connections:			
LSR16	16" dia. (400mm) Tank c/w 1.5"MPV	50kg	460.00
LSR18	18" dia. (450mm) Tank c/w 1.5"MPV	75kg	556.00
LSR20	20" dia. (500mm) Tank c/w 1.5"MPV	100kg	673.00
LSR24	24" dia. (610mm) Tank c/w 1.5"MPV	125kg	705.00
2" Connections:			
LSR30	30" dia. (762mm) Tank c/w 2"MPV	200kg	1,184.00

Lacron Sureflow LSC Side Mount Filters - Tank only



Prices are for Filter only.

Filter Sand & Pea Gravel is purchased separately.

Refer to page 198 for filter media.

Code	Description	Media Required	Price
63mm/2" Connections:			
LSC36	36" dia. (915mm) Filter	300kg sand/75kg gravel	1,596.00
90mm/3" Connections:			
LSC36	36" dia. (915mm) Filter	300kg sand/75kg gravel	2,041.00
LSC42	42" dia. (1100mm) Filter	450kg sand/100kg gravel	2,747.00
LSC48	48" dia. (1220mm) Filter	675kg sand/175kg gravel	4,244.00

Specifically designed for light to medium commercial installations.

Delivery Charges applicable for this filter - please ask

Lacron MBF & DBF Finaflow Deep Bed Filters - Tank only with Hatch & Sight Glass (no filter media, external connections or multiport valve)



Lacron DBF Finaflow Filter



Lacron MBF Finaflow Filter

Code	Description	Media Required	Price
50mm/1.5" Connections:			
MBF24	24" dia. (610mm) MBF Tank	350kg sand/75kg gravel	1,760.00
63mm/2" Connections:			
MBF30	30" dia. (760mm) MBF Tank	550kg sand/100kg gravel	2,230.00
50mm/1.5" Connections:			
DBF18	18" dia. (450mm) DBF Tank <small>18" does not have a hatch and sight glass</small>	250kg sand/50kg gravel	1,990.00
63mm/2" Connections:			
DBF24	24" dia. (610mm) DBF Tank	500kg sand/75kg gravel	3,110.00
DBF30	30" dia. (760mm) DBF Tank	775kg sand/100kg gravel	3,900.00
90mm/3" Connections:			
DBF36	36" dia. (915mm) DBF Tank	950kg sand/125kg gravel	4,800.00
DBF42	42" dia. (1100mm) DBF Tank	1650kg sand/150kg gravel	5,510.00

Hard wearing glass reinforced polyester.
Hydraulically balanced laterals to maximise water flow.

Inflow diffuser to equally distribute flow across the filter bed surface.
Media sight glasses are fitted for observing the condition of media bed.

Lacron Filter Spares

Please ask for a price on items not listed - state filter model/type & diameter

Universal Lacron Filter Spares

No.	Code	Description	Price
1	SPL0880P	Lid Removal Tool - Metal	46.00
1	SPL0882	Lid Removal Tool - Plastic	17.50
2	SPL0849	Lid - 8" (204mm) - New Type	69.90
3	SPL0851	Lid "O" Ring 8"	11.90
2	SPL0846	Lid - 6" (152mm)	47.10
3	SPL0847	Lid "O" Ring 6"	14.78
4	SPL0887P	Rose Distributor	11.80
5	SPL0884	Self Tapping Screws - Pack of 10	3.50
7	SPL0853	Air Bleed Tube Cap	3.75
8	SPL0856T	Air Bleed Tube - 1 metre long	7.20
17	SPL0852	Drain Plug Complete	15.30
21	SPL0852C	Drain Plug Cap only	6.40

13 Lacron Lateral Sets

Code	Description	Price
Standard Lateral Sets:		
LALS018	16" & 18" Lateral Set (6 x 120mm)	53.00
LALS024	24" Lateral Set (4 x 120mm, 6 x 180mm)	94.50
LALS030	30" Lateral Set (4 x 120mm, 4 x 180mm, 6 x 240mm)	125.65
LALS036-2"	36" Lateral Set (4 x 120mm, 4 x 180mm, 12 x 240mm)	140.00
LALS036-3"	36" Lateral Set (4x120mm,4x180mm,4x240mm,4x280)	140.00
LALS042	42" Lateral Set (4 x 60mm, 4 x 180mm, 12 x 280mm)	220.00
Heavy Duty Lateral Sets:		
HDLS018	18" HD Set (6 x 113mm)	POA
HDLS024	24" HD Set (4 x 113mm, 6 x 206mm)	POA
HDLS030	30" HD Set (4 x 113mm, 4 x 206mm, 6 x 238mm)	POA
HDLS036	36" HD Set (4 x 113mm, 4 x 206mm, 12 x 238mm)	POA
HDLS042	42" HD Set (4 x 82mm, 4 x 238mm, 12 x 300mm)	POA

14 Underdrain without laterals

Filter Size	Code	Description	Price
18" dia	SPL0881S	1.5" Underdrain	43.00
24" dia	SPL1367	1.5" Underdrain	48.00
30" dia	VLA46	2" Underdrain	83.50
36" dia	VLA47	2" Underdrain	238.00
42" dia	SPL0896	LHS Underdrain	112.00
42" dia	SPL0897	Underdrain "T" & Conn Pipe	131.50
42" dia	SPL0898	RHS Underdrain	112.00

15 Bulkhead Fitting including Nut - each

Filter Size	Code	Description	Price
18" dia	SPL0890	1.5" Bulkhead Fitting	30.00
24" dia	SPL0890	1.5" Bulkhead Fitting	30.00
30" dia	SPL0891	2" Bulkhead Fitting	35.00
36" dia	SPL0891	2" Bulkhead Fitting	35.00
36" dia	SPL0899	3" Bulkhead Fitting (6017)	50.00
42" dia	SPL0899	3" Bulkhead Fitting (6017)	50.00
42" dia	SPL0903	3" Bulkhead Fitting Top (1525A)	69.66
42" dia	SPL0965	3" Bulkhead Fitting Bottom	74.78

16 Bulkhead Gaskets - Set of 2

Filter Size	Code	Description	Price
18" dia	SPL0861P	1.5" Gaskets	12.00
24" dia	SPL0861P	1.5" Gaskets	12.00
30" dia	SPL0864	2" Gaskets	28.50
36" dia	SPL0864	2" Gaskets	28.50
36" dia	SPL0900	3" Gaskets	24.00
42" dia	SPL0900	3" Gaskets	24.00

Example - Lacron 36" dia. Filter Layout

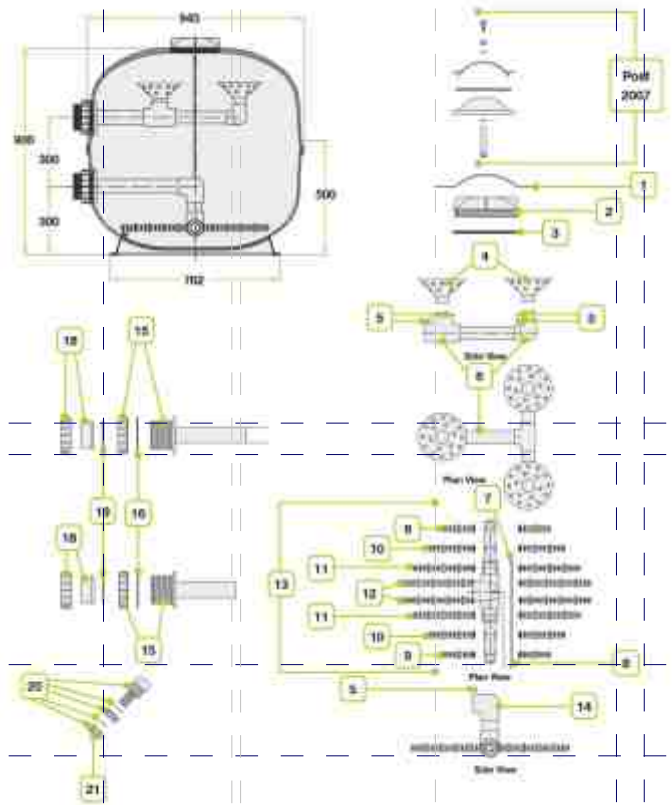

5 Header without rose/s

Filter Size	Code	Description	Price
18" dia	VLA48	1.5" Header	45.00
24" dia	VLA49	1.5" Header	45.00
30" dia	VLA1370	2" Header	73.00
36" dia	VLA1370	2" Header	73.00
42" dia	SPL0893	3" LHS Header	93.50
42" dia	SPL0894	3" RHS Header	93.50

18 Adaptor Union including sleeve

Filter Size	Code	Description	Price
18" dia	SPL0866P	1.5" Adaptor Union - Set of 2	25.00
24" dia	SPL0866P	1.5" Adaptor Union - Set of 2	25.00
30" dia	SPL0867P	2" Adaptor Union - Set of 2	28.00
36" dia	SPL0867P	2" Adaptor Union - Set of 2	28.00
36" dia	SPL0913	3" Adaptor Union - Each	38.00
42" dia	SPL0913	3" Adaptor Union - Each	38.00

19 Union Adaptor Flat Gaskets - Set of 2

Filter Size	Code	Description	Price
18" dia	SPL0863	1.5" Gaskets	9.00
24" dia	SPL0863	1.5" Gaskets	9.00
30" dia	SPL0862P	2" Gaskets	12.00
36" dia	SPL0862P	2" Gaskets	12.00
36" dia	SPL0912	3" Gaskets	18.00
42" dia	SPL0912	3" Gaskets	18.00

Please Note: Does your Union Adaptors have "O" Rings instead of flat gaskets
If so, please ask for assistance.

Triton Filters - Side Mount MPV



Atika Filters were previously a substitute for TRITON filters.

TR 40 = 19" dia.
TR 60 = 24" dia.
TR 100 = 30" dia.
TR 140 = 36" dia.

All Filters are supplied c/w Multiport Valve & Pressure Gauge only

Code	Description	Media Required	Price
TRT19	19" dia. Tank - 1.5"MPV	50kg / 25kg	742.00
TRT24	24" dia. Tank - 1.5"MPV	100kg / 50kg	873.50
TRT30	30" dia. Tank - 2"MPV	200kg / 75kg	1,290.00
TRT36	36" dia. Tank - 2"MPV	325kg / 125kg	1,715.00

Tagelus Filters - Top Mount MPV



Atika Filters were previously a substitute for the Tagelus Top Mount range.

TA 40 = 19" dia.
TA 60 = 24" dia.
TA 100 = 30" dia..

Filters are supplied c/w Multiport Valve & Pressure Gauge only

Code	Description	Sand / Gravel	Price
TA40	19" dia. Tank - 1.5"MPV	75kg / 25kg	523.50
TA60	24" dia. Tank - 1.5"MPV	150kg / 25kg	628.00
TA100	30" dia. Tank - 2"MPV	250kg / 50kg	931.50

Triton/Atika Side Mount Filters Spares

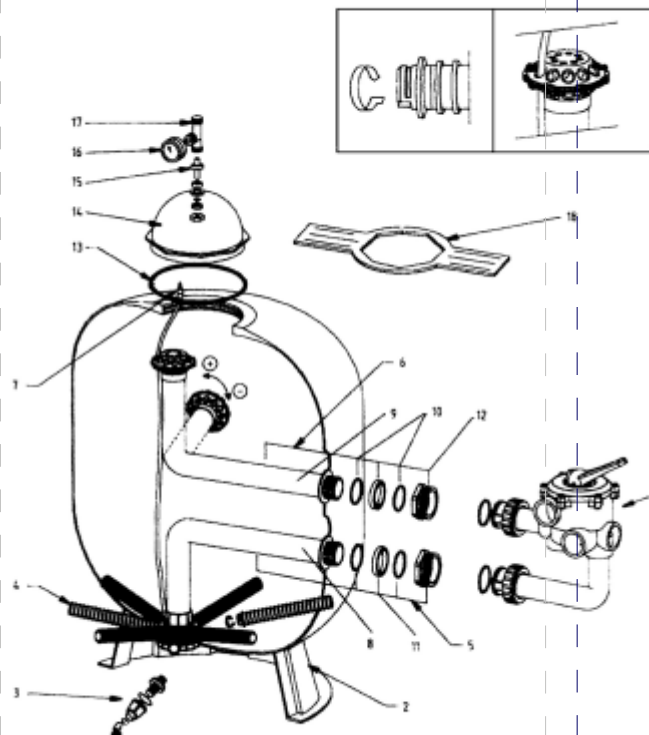

Tagelus/Atika Top Mount Filter Spares

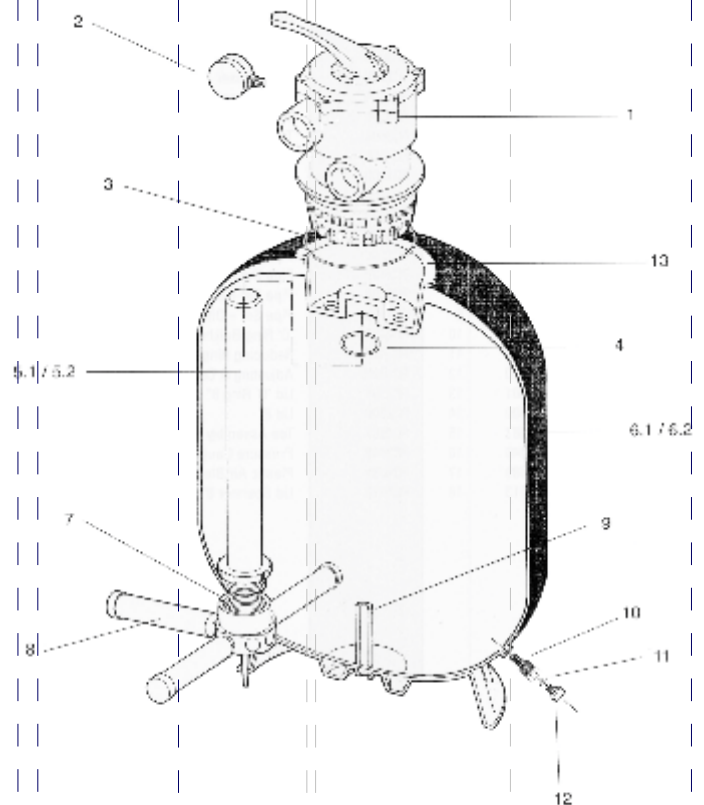

For a list of spares & prices for your 19", 24", 30", & 36" diameter Triton/Tagelus/Atika Filter, please contact us: technical@leisureteq.co.uk