

# X10-710 V8.0 servo with Soft Start

## Technical Specification

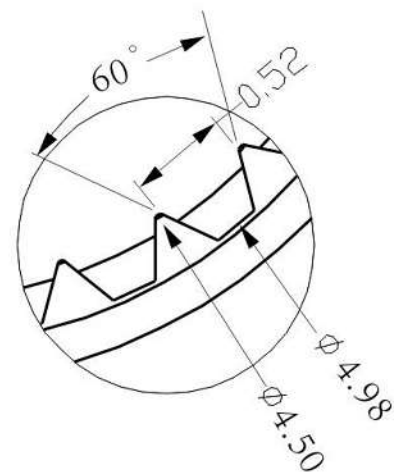
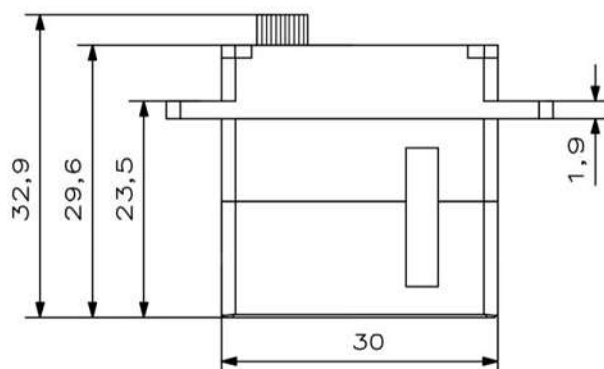
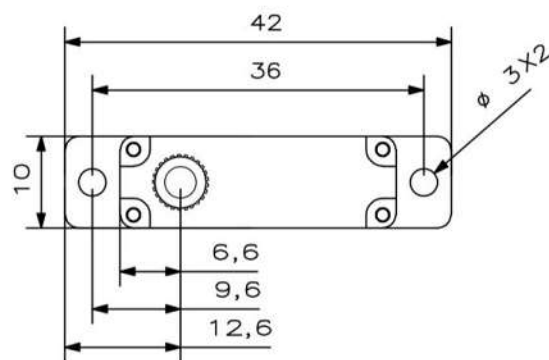

Content is subject to change without notice 2021/02

## Operating Data

|                                    | <b>X10-710</b>        |
|------------------------------------|-----------------------|
| <b>Operation Voltage(rated)</b>    | DC7.4V                |
| <b>Operation Voltage Range</b>     | DC4.8V-8.4V           |
| <b>Stalling Torque</b>             | 4.5Kg.cm@4.8V         |
|                                    | 5.5Kg.cm@6.0V         |
|                                    | 6.8Kg.cm@7.4V         |
|                                    | 7.50Kg.cm@8.4V        |
| <b>Speed</b>                       | 0.16sec/60°@4.8V      |
|                                    | 0.14sec/60°@6.0V      |
|                                    | 0.12sec/60°@7.4V      |
|                                    | 0.10sec/60°@8.4V      |
| <b>Travel Angle</b>                | ±50° when 1000-2000us |
| <b>Operating Temperature Range</b> | -10°C……+65°C          |

## Performance

**X10-710**

**@7.4V**

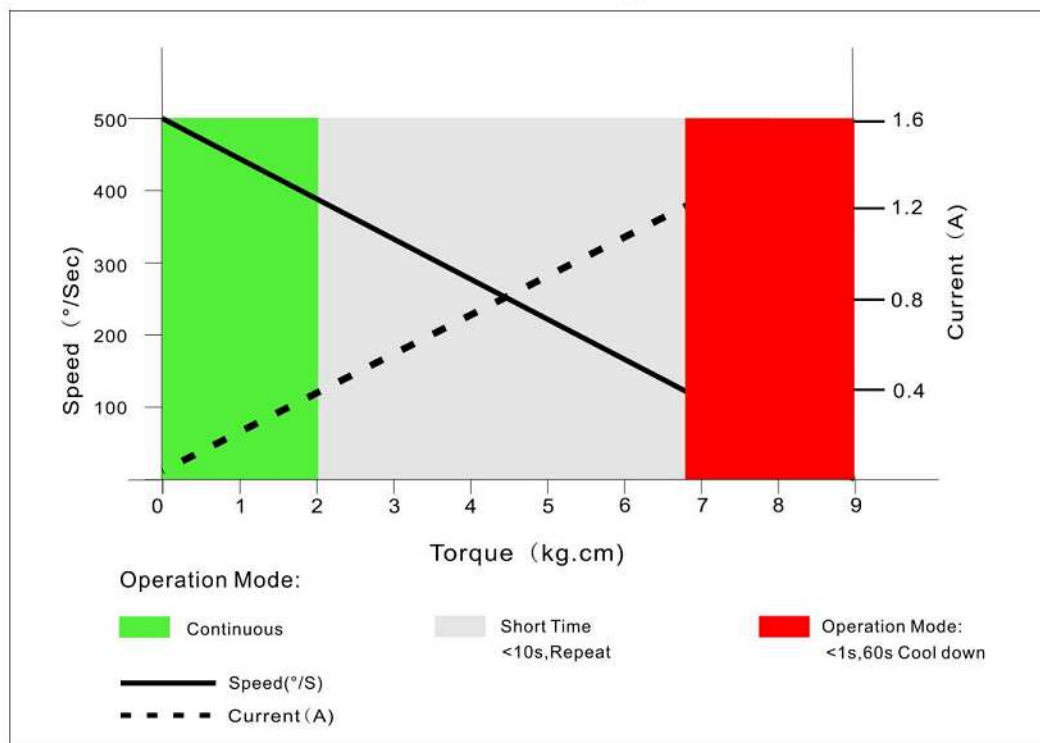

## PWM Command Signal

| PWM  | X10-710   |
|--|---|
| Signal Voltage                               | TTL-Level: HIGH:min.3.3V,max.5.0V<br>TTL-Level: Low:min.0.0V,max.1.5V |
| Pulse Lengths                                | 900-2100us  |
| Pulse Lengths for Position -50° /center/+50° | 1000us/1500us/2000us  |
| Resolution                                   | <=2us   |

### Materials and protective features

|                   |                                 |
|-------------------|---------------------------------|
| Case Material     | Aluminum Alloy                  |
| Motor Type        | Coreless                        |
| Gear Material     | Hardened Steel                  |
| Position Sensor   | Potentiometer                   |
| Position Feedback | Optional (PWM signal,305Hz,5mA) |
| Connecting Cable  | 26AWG                           |

### Dimensions

|                 |            |
|-----------------|------------|
| Case Dimensions | 30*10*30mm |
| Weight          | 23g        |