

X15-855X V3.0 Technical Specification

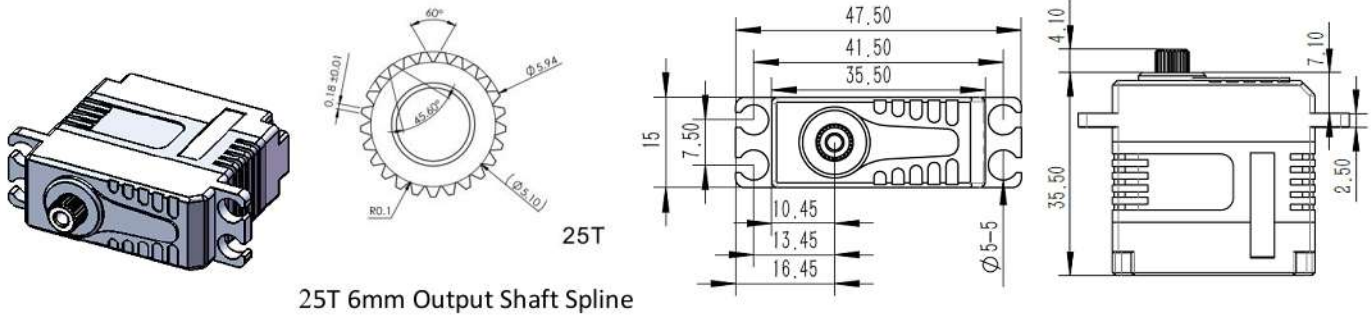

25T 6mm Output Shaft Spline

1. Operating Data

| | |
|-------------------|--------------------------|
| | X15-855X |
| Rated Voltage | DC7.4V |
| Voltage Range | DC6.0V-8.4V |
| Stalling Torque | 1.0N.m@6.0V |
| | 1.3N.m@7.4V |
| | 1.5N.m@8.4V |
| Speed | 0.07sec/60°@6.0V |
| | 0.06sec/60°@7.4V |
| | 0.05sec/60°@8.4V |
| Working Frequency | 760us/560Hz |
| Temperature Range | -10°C.....+65°C |
| Case Material | Aluminum Alloy |
| Motor Type | Brushless DC Motor |
| Gear Set Material | Hardened Steel |
| Position Sensor | Potentiometer |
| Ball Bearing | 2BB |
| Case Dimensions | 35.5mm*15mm*35.5mm±0.2mm |
| Weight | 45g±10% |

28g

2. Performance

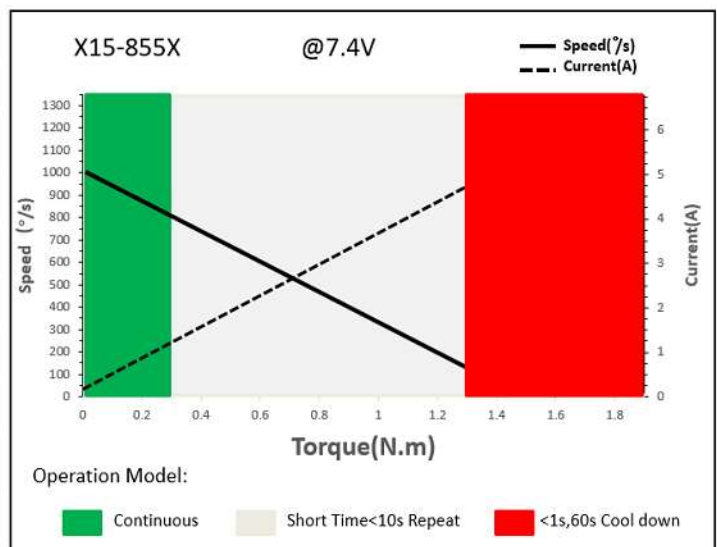

3. Command signal

PWM Command Interface

| | |
|-------------------|---|
| Signal Voltage | HIGH: min.3.3V, max.5.0V Low: min.0.0V, max.1.5V |
| Pulse Lengths | 450us-1050us |
| Working Frequency | 760us/560Hz |

4. Electrical Connection

| <p>3 2 1</p> | Pin Assignment | | | |
|--------------|----------------|--------|--------|----------------|
| | 1 | Orange | Signal | PWM Command |
| | 2 | Red | DC+ | Supply Voltage |
| | 3 | Brown | DC- | Supply Ground |