

A15-1812 V8.0

Technical Specification

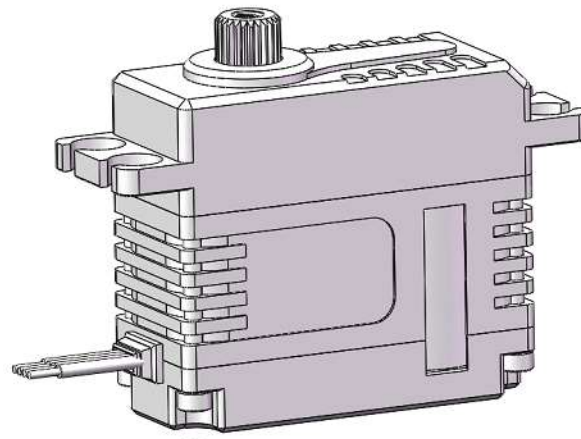

1. Installation Dimensions

| | |
|-----------------|---------------------------|
| Case Dimensions | 35.5mm*15mm*32.5mm ±0.2mm |
| Weight | 42g ±10% |

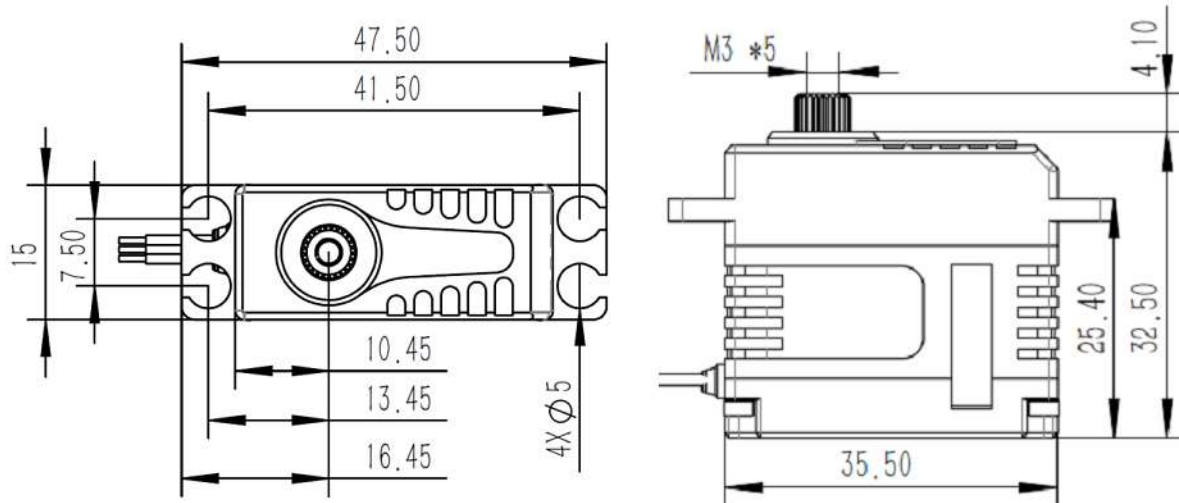

2. Operating Data

| | |
|-----------------------------|-------------------------|
| Operation Voltage(Rated) | DC7.4V |
| Operation Voltage Range | DC6.0V-8.4V |
| Rated Torque | 0.5N.m@7.4V |
| Stalling torque | 1.8N.m@7.4V |
| No-load Speed | 0.12sec/60°@7.4V |
| Rated Speed | 0.18sec/60°@7.4V |
| Travel Angle | ±50° when 1000us-2000us |
| | ±100° when 500us-2500us |
| Operating Temperature Range | -20°C.....+65°C |

3. Performance

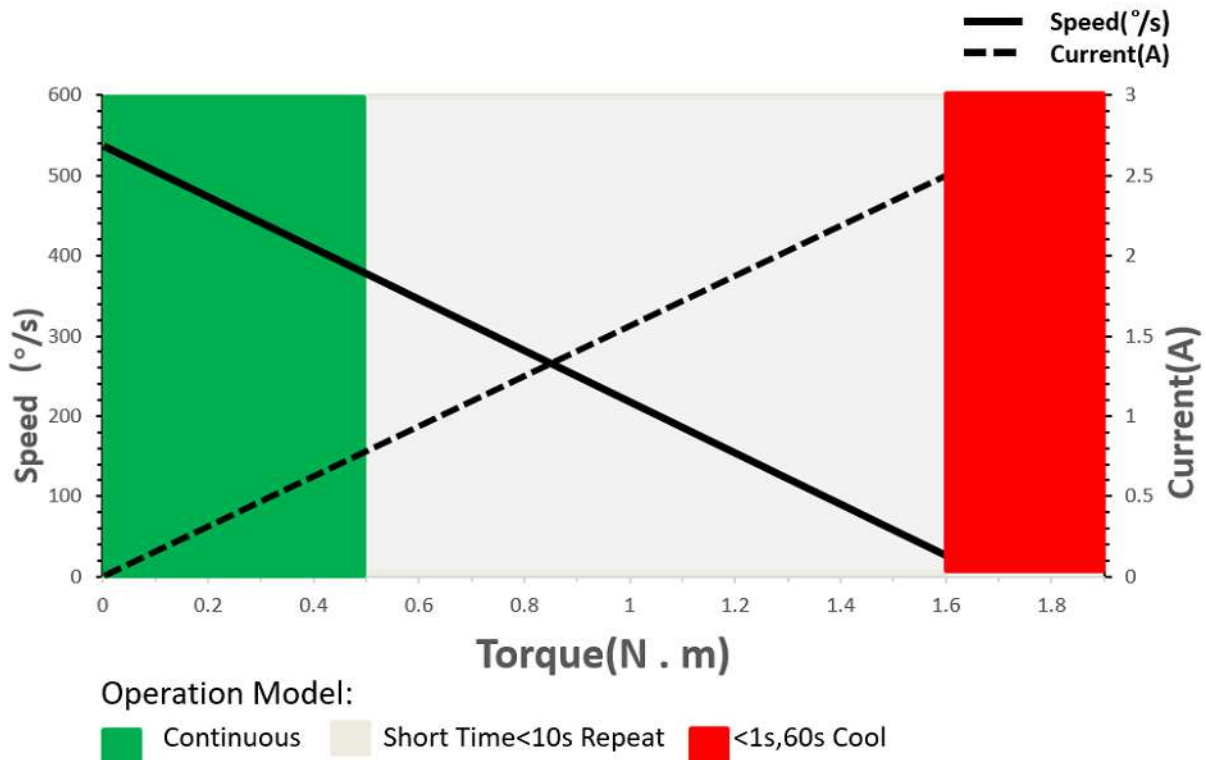

4. PWM Command Signal

| | |
|--|---|
| Signal Voltage | TTL-Level: HIGH:min.3.3V,max.5.0V TTL-Level: Low:min.0.0V,max.1.5V |
| Pulse Lengths | 500us - 2500us |
| Pulse Lengths for Position -100°/center/+100° | 500us/1500us/2500us |

5. Materials and protective features

| | |
|-------------------|----------------|
| Case Material | Aluminum Alloy |
| Motor Type | Brushless |
| Gear Set Material | Hardened Steel |
| Position Sensor | Potentiometer |
| Connecting Cable | 26AWG |

6. Output Shaft Spline

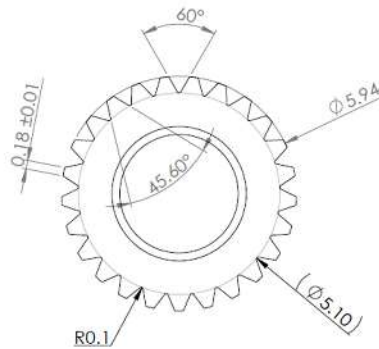

7. Electrical Connection

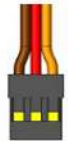
| | | | | |
|--|----------------|--------|-------|------------------------------|
|  3 2 1 | Pin Assignment | | | |
| | 1 | Yellow | SIG | Command Signal |
| | 2 | Red | +V DC | Supply Voltage |
| | 3 | Brown | GND | Supply Ground, Signal Ground |

8. Accessories (Optionals)

| Item | Item-No. |
|----------------------------------|----------------|
| Aluminum Servo Arm (Single side) | 0625.11 |
| Aluminum Servo Arm (Single side) | 0625.23 |
| Aluminum Servo Arm (Single side) | 0625.40 |
| Aluminum Servo Arm (Double side) | 0625.60 |

Item No.: 0625.11

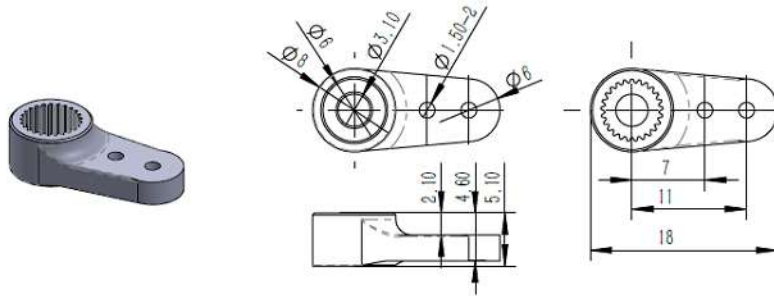

Item No.: 0625.23

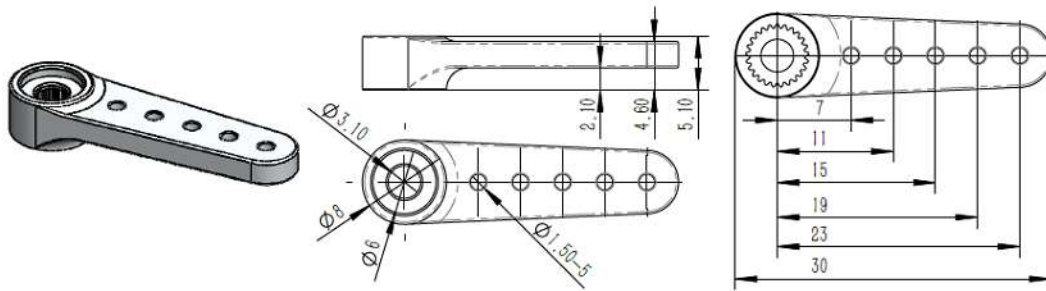

Item No.: 0625.40

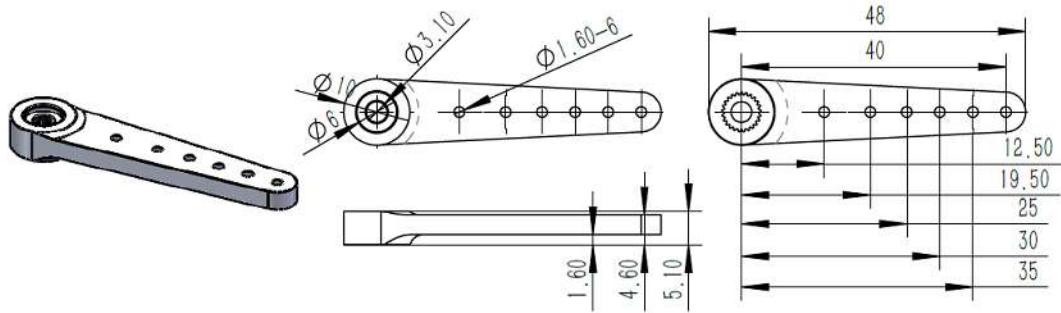

Item No.: 0625.60

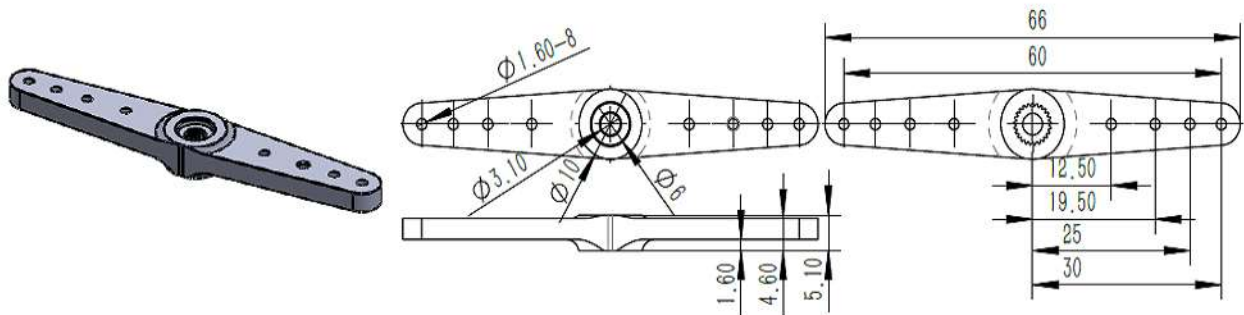

9. Item Number System

| <u>A15 - 1812</u> | |
|--------------------|---------------------------------|
| Servo Class | Performance |
| 15mm Class | 18: Stalling Torque (1.8N.m) |
| | 12: No-load Speed (0.12Sec/60°) |