



# ROSSCADO

THREADING  
FILETAGE



**GIRAMACHOS CON CRIQUE IZQ-DCH**  
TAP HOLDER WITH RATCHET, LEFT-RIGHT HAND  
PORTE TARAUDS



Nº	Para machos / For Taps	∅ (mm)	L1 (mm)	Peso / Weight (kg)	Uds. / Pcs.	Cod.	€/Unid.
1	M 3 - 10    1/8 - 3/8	2,4 - 5,5	85	0,165	1	1R10001	19,48
2	M 5 - 12    7/32 - 1/2	4,5 - 8,0	100	0,310	1	1R10002	24,67
10	M 3 - 10    1/8 - 3/8	2,4 - 5,5	250	0,250	1	1R10010	32,45
20	M 5 - 12    7/32 - 1/2	4,5 - 8,0	300	0,440	1	1R10020	38,95

**GIRAMACHOS AJUSTABLES DE ZINC FUNDIDO DIN1814**  
ZINC ADJUSTABLE TAP WRENCHES DIN 1814  
PORTE TARAUDS EN ZINC DIN 1814



DIN 1814

Nº	Para machos / For Taps	∅ (mm)	L1 (mm)	Peso / Weight (kg)	Uds. / Pcs.	Cod.	€/Unid.
0	M 1 - 8    1/16 - 1/4	2,0 - 5,0	130	0,050	1	1R13000	8,87
1	M 1 - 10    1/16 - 3/8    G 1/8	2,0 - 6,3	176	0,095	1	1R13010	9,14
1.1/2	M 1 - 12    1/16 - 1/2    G 1/8	2,1 - 8,0	176	0,120	1	1R13015	9,14
2	M 4 - 12    5/32 - 1/2    G 1/8	3,0 - 9,0	280	0,285	1	1R13020	14,67
3	M 5 - 20    7/32 - 3/4    G 1/8 - 1/2	4,9 - 12,0	380	0,660	1	1R13030	24,77
4	M 11 - 27    7/16 - 1    G 1/4 - 3/4	5,5 - 16,0	505	1,500	1	1R13040	44,26
5 L	M 13 - 32    1/2 - 1.1/4    G 1/4 - 1	7,0 - 20,0	700	1,800	1	1R13050	69,04

**GIRAMACHOS AJUSTABLES DE ACERO DIN 1814**  
STEEL ADJUSTABLE TAP WRENCHES DIN 1814  
PORTE TARAUDS EN ACIER DIN1814

DIN 1814



Nº	Para machos / For Taps		∅ (mm)	L1 (mm)	Peso / Weight (kg)	Uds. / Pcs.	Cod.	€/Unid.
0	M 1 - 8	1/16 - 1/4	2,0 - 5,0	130	0,050	1	1R14000	17,70
1	M 1 - 10	1/16 - 3/8	2,0 - 6,3	176	0,100	1	1R14010	16,92
1.1/2	M 1 - 12	1/16 - 1/2	G 1/8	2,1 - 8,0	176	1	1R14015	17,96
2	M 4 - 12	5/32 - 1/2	G 1/8	3,0 - 9,0	280	1	1R14020	22,56
3	M 5 - 20	7/32 - 3/4	G 1/8 - 1/2	4,9 - 12	380	1	1R14030	34,88
4	M 11 - 27	7/16 - 1	G 1/4 - 3/4	5,5 - 16	500	1	1R14040	64,27
5	M 13 - 32	1/2 - 1.1/4	G 1/4 - 1	7 - 20	700	1	1R14050	107,54
6	M 18 - 42	3/4 - 1.1/2	G 1/2 - 1.1/4	11 - 24	1000	1	1R14060	114,10
7	M 25 - 52	1 - 2.1/8	G 3/4 - 2.1/4	16 - 32	1250	1	1R14070	192,79
8	M 25 - 64	1 - 2.1/2	G 3/4 - 3	16 - 40	1250	1	1R14080	438,33

**PROLONGADOR PARA MACHOS DIN 377**  
TAP EXTENSION DIN 377  
EXTENSION POUR TARAUDS

DIN 377



∅ (mm)	Dmin	Dmax	L1	Para / For DIN 352	Cod.	€/Unid.
2,1	5	2,7	60	M 1-2.6	1R14521	8,54
2,4	6	3	70		1R14524	8,54
2,7	7	3,5	80	M 3	1R14527	8,54
3,0	7	4	90	M 3.5	1R14530	8,54
3,4	8	4,5	95	M 4	1R14534	8,81
3,8	9	5	100		1R14538	9,34
4,3	10	5,5	105		1R14543	10,15
4,9	11	6	110	M 4.5-8	1R14549	10,41
5,5	12	7	115	M 9-10	1R14555	10,68
6,2	14	8	120	M 11	1R14562	14,16
7,0	15	9	125	M 12	1R14570	14,68
8,0	17	10	125		1R14580	16,55
9,0	19	12	130	M 14-16	1R14590	19,47
10,0	21	13	140		1R14610	23,78
11,0	23	14	150	M 18	1R14611	27,50
12,0	25	16	155	M 20	1R14612	30,70
13,0	27	17	165		1R14613	40,84
14,5	29	18	175	M 22-24	1R14614	46,98
16,0	30	20	180	M 27	1R14616	48,65
18,0	33	22	200	M 30	1R14618	56,35
20,0	36	25	220	M 33	1R14620	75,83
22,0	38	28	220	M 36	1R14622	102,79
24,0	42	32	235	M 39-42	1R14624	126,55
26,0	45	34	250		1R14626	154,72
29,0	50	36	265	M 45-48	1R14629	186,36
32,0	55	40	285	M 52	1R14632	257,44

CONSTRUCCIÓN  
CONSTRUCTION • CONSTRUCTION

MADERA  
WOOD • BOIS

METAL  
METAL • MÉTAL

FRESADO  
MILLING • FRAISAGE

ROSCADO  
THREADING • FILETAGE

ACCESORIOS  
ACCESSORIES • ACCESSOIRES

HEXAGONAL  
HEXAGONAL • HEXAGONAL

METROLOGÍA  
METROLOGY • MÉTROLOGIE

DISPLAYS  
DISPLAYS • DISPLAYS



## VOLVEDORES ZINC FUNDIDO DIN 225 (EN 22568)

ZINC DIE HOLDERS DIN 225 (EN 22568)  
PORTE FILIÈRES DIN 225 (EN 22568) EN ZINC

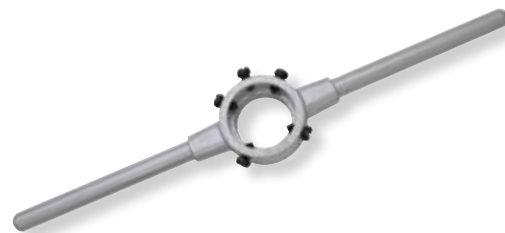

DIN 225

DIN 22568

Ø (mm)	Para cojinetes / For Taps		L1 (mm)	Peso / Weight (kg)	Uds. / Pcs.	Cod.	€/Unid.	
16 x 5	M	1,0 - 2,6	BSW 1/16 - 3/32	160	0,050	1	1R15001	5,77
20 x 5	M	3,0 - 4,0	BSW 1/8 - 5/32	200	0,065	1	1R15002	6,02
20 x 7	M	4,5 - 6,0	BSW 3/16 - 1/4	200	0,065	1	1R15003	6,02
25 x 9	M	7,0 - 9,0	BSW 5/16	224	0,105	1	1R15004	6,74
30 x 11	M	10,0 - 11,0	BSW 3/8 - 7/16	280	0,190	1	1R15005	11,09
38 x 10	Mf	12,0 - 15,0	G 1/4	315	0,340	1	1R15006	17,33
38 x 14	M	12,0 - 15,0	BSW 1/2 - 9/16	315	0,340	1	1R15007	17,33
45 x 14	Mf	16,0 - 21,0	G 3/8 - 1/2	450	0,650	1	1R15008	20,47
45 x 18	M	16,0 - 20,0	BSW 5/8 - 13/16	450	0,650	1	1R15009	20,47
55 x 16	Mf	22,0 - 26,0	G 5/8 - 3/4	560	0,900	1	1R15010	26,49
55 x 22	M	22,0 - 24,0	BSW 7/8 - 1	560	0,900	1	1R15011	26,49
65 x 18	Mf	27,0 - 36,0	G 7/8 - 1	630	1,400	1	1R15012	44,55
65 x 25	M	27,0 - 36,0	BSW 1.1/8 - 1.3/8	630	1,400	1	1R15013	44,55

## VOLVEDORES ZINC FUNDIDO EN PULGADAS - 3 TORNILLOS

ZINC DIE HOLDERS IN INCH 3 SCREWS  
PORTE FILIÈRES EN POUÇES À 3 VISSÉS



Ø (")	Para cojinetes / For Taps		L1 (mm)	Peso / Weight (kg)	Uds. / Pcs.	Cod.	€/Unid.
13/16	20,6 x 6,35	13/16 x 1/4	200	0,060	1	1R15520	6,49
1	25,4 x 9,5	1 x 3/8"	224	0,100	1	1R15525	6,75
1.5/16	33,4 x 11,1	1.5/16 x 7/16	270	0,180	1	1R15533	10,00
1.1/2	38,1 x 12,7	1.1/2 x 1/2	315	0,320	1	1R15538	18,76
2	50,8 x 15,9	2 x 5/8	560	0,900	1	1R15550	30,01
2.1/4	57,1 x 17,5	2.1/4 x 11/16	560	0,900	1	1R15557	30,01
2.1/2	63,5 x 19,0	2.1/2 x 3/4	630	1,400	1	1R15563	46,28
3	76,2 x 22,2	3 x 7/8"	800	2,200	1	1R15576	105,06
3.1/2	88,9 x 25,4	3.1/2 x 1	900	3,300	1	1R15588	130,08
4	101,6 x 25,4	4 x 1	1.000	3,600	1	1R15599	412,76

## VOLVEDORES ACERO DIN 225 (EN 22568)

STEEL DIE HOLDERS DIN 225 (EN 22568)

PORTE FILIÈRES DIN 225 (EN 22568) EN ACIER

DIN 225

DIN 22568



Ø (mm)	Para cojinetes / For Taps		L1 (mm)	Peso / Weight (kg)	Uds. / Pcs.	Cod.	€/Unid.
45 x 18	M 16 - 20	BSW 5/8 - 13/16	450	0,650	1	1R15209	30,26
55 x 22	M 22 - 24	BSW 7/8 - 1	560	0,900	1	1R15211	43,01
65 x 25	M 27 - 36	BSW 1.1/8 - 1.3/8	630	1,400	1	1R15213	55,74
75 x 20	Mf 38 - 42	G 1.1/8 - 1.1/4	800	2,250	1	1R15214	89,40
75 x 30	M 38 - 42	BSW 1.1/2 - 1.5/8	800	2,100	1	1R15215	89,40
90 x 22	Mf 45 - 52	G 1.3/8 - 1.5/8	900	3,200	1	1R15216	111,06
90 x 36	M 45 - 52	BSW 1.3/4 - 2	900	3,000	1	1R15217	111,06
105 x 22	Mf 54 - 63	G 1.3/4 - 2	975	3,500	1	1R15218	177,16
105 x 36	M 54 - 63	BSW 2.1/4	975	3,500	1	1R15219	177,16
120 x 22	Mf 64 - 71	G 2.1/4 - 2.3/4	956	3,170	1	1R15220	448,80
120 x 36	M 64 - 71	BSW 2.1/2 - 2.3/4	956	3,910	1	1R15221	448,80
130 x 25		G 3	966	3,505	1	1R15222	637,76
130 x 36			966	4,025	1	1R15223	803,10
140 x 22			976	3,620	1	1R15224	803,10
150 x 25		G 3.1/2	986	3,950	1	1R15226	911,76
160 x 25		G 4	996	4,115	1	1R15228	1.251,88

## ACEITE DE CORTE Y ROSCADO

CUTTING AND TAPPING FLUID

FLUIDE POUR FILETAGE ET DE COUP

Contenido / Content	Uds.	Cod	€/Unid.
400 ml	1	1AC4000	19,10

Metales duros y blandos. Alto poder refrigerante y anticorrosivo.  
Suitable for hard and soft metals. High refrigerating and anti-corrosion capacity.  
Métaux doux et durs. Haut pouvoir anticorrosion.



## EXTRACTOR DE TORNILLOS 5 PIEZAS ADVANCE

5 PCS ADVANCE SCREW EXTRACTORS  
EXTRACTEURS DE VIS ADVANCE 5 PCS



Para Tornillos / Screws	Uds. / Pcs.	Cod.	€/Unid.
3 - 22	5	6Z00GR30	51,79

Broca / Drill Bit	m (mm)	C (mm)	L (mm)
3	2,7	5	51
4	3,3	5	68
5	4,6	6	66
6	5,5	8	73
8	6,7	10	80

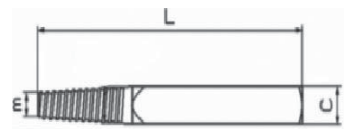

## EXTRACTOR DE TORNILLOS STANDARD

STANDARD SCREW EXTRACTORS  
EXTRACTEURS DE VIS STANDARD



Para Tornillos / Screws	Uds. / Pcs.	Cod.	€/Unid.
3 - 18	5	6Z00GR15	15,67
3 - 24	6	6Z00GR16	19,50
3 - 45	8	6Z00GR18	39,38



## JUEGOS DE MACHOS ESTRIADOS 5 PIEZAS

FLUTES TAPS SET - 5 PCS  
JEU DE TARAUDS CANÉLÉS 5 PCS

Para Tornillos / Screws	Uds. / Pcs.	Cod.	€/Unid.
5 - 14	5	6Z00ST01	94,73

Contenido / Contains / Contenu

Extractor	Broca / Drill Bit	H (mm)	L (mm)	LE (mm)
H1	4,0	16	10	57
H2	5,0	16	11	68
H3	6,0	16	13	78
H4	7,5	16	14	84
H5	8,5	16	16	94

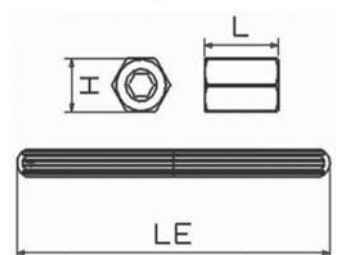

## JUEGOS DE BROCAS Y GUIAS EXTERIORES E INTERIORES

FULL SET WITH 5 DRILLS AND EXTERNAL AND INTERNAL GUIDES  
JEU COMPLET AVEC 5 FORETS ET 10 INTERNE ET EXTERNE GUIDES



Para Tornillos / Screws	Uds. / Pcs.	Cod.	€/Unid.
5 - 14	25	6Z00ST02	195,87

Contenido / Contains / Contenu

Guía / Guide	1	2	3	4	5	6	7	8	9	10
Ext.	M5	M6	M7	M8	M8	M9	M10	M11	M12	M14
Int.	-	M6	M8	3/8"	1/2"	M10	7/16"	M12	M14	M16
Broca / Drill Bit	4	4	4	4	5	5	5	6	7,5	8,5
Extractor	H1	H1	H1	H1	H2	H2	H2	H3	H4	H5

Instrucciones de uso / Instructions / Mode d'emploi

INTERIOR

EXTERIOR

- Taladrar el espárrago roto con el diámetro correspondiente.
- Se introduce el extractor con un golpe de martillo.
- Con una llave se gira en sentido inverso a la rosca.
- Drill the broken screw with the diameter wich corresponds.
- The extractor is introduced with a hammer.
- With a wrench turn the inverse way to the screw.

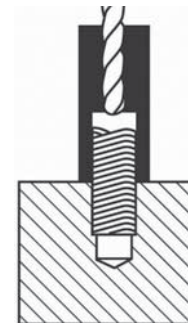

## EXTRACTORES DE ESPÁRRAGOS SALIENTES

STUD EXTRACTORS • EXTRACTEURS DE GOUJONS



Para Tornillos / Screws	A (mm)	B (mm)	C (mm)	Cod.	€/Unid.
4,5 - 9,5	12	46	25	6Z00GR31	83,50
8 - 19	21	60	31	6Z00GR32	128,29
15 - 25	30	68	38	6Z00GR33	198,03

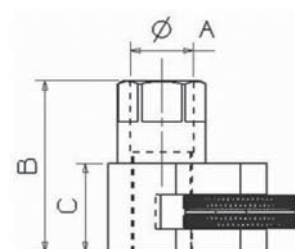

CONSTRUCCIÓN  
CONSTRUCTION • CONSTRUCTION  
  
 MADERA  
WOOD • BOIS  
  
 METAL  
METAL • MÉTAL  
  
 FRESADO  
MILLING • FRAISAGE  
  
 ROSCADO  
THREADING • FILETAGE  
  
 ACCESORIOS  
ACCESSORIES • ACCESSOIRES  
  
 HEXAGONAL  
HEXAGONAL • HEXAGONAL  
  
 METROLOGÍA  
METROLOGY • MÉTROLOGIE  
  
 DISPLAYS  
DISPLAYS • DISPLAYS

# M JUEGOS DE MACHOS MÉTRICA ISO-ROSCA DIN 13 CON COLGADOR NEW

METRIC ISO-THREAD DIN 13 HAND TAPS - WITH HANGER  
JEUX DE TARAUDS À MAIN, METRIQUE DIN-13 - AVEC CROCHET



HSS-G

DIN 352

TOL 6H

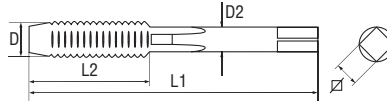

D Ø x P (mm)	L1 (mm)	L2 (mm)	D2 (mm)	∅ (mm)	Cod.	€/Set
M 3 x 0.50	40	11.0	3.5	2.7	2R27326BL	20,55
M 4 x 0.70	45	13.0	4.5	3.4	2R27330BL	19,54
M 5 x 0.80	50	16.0	6.0	4.9	2R27334BL	20,55
M 6 x 1.00	50	19.0	6.0	4.9	2R27338BL	20,55
M 8 x 1.25	56	22.0	6.0	4.9	2R27342BL	22,97
M 10 x 1.50	70	24.0	7.0	5.5	2R27346BL	31,13
M 12 x 1.75	75	29.0	9.0	7.0	2R27350BL	40,75

# M MÉTRICA ISO-ROSCA DIN 13 CON COLGADOR NEW

METRIC ISO-THREAD DIN 13 WITH HANGER  
MÉTRIQUE DIN-13 AVEC CROCHET



HSS-G

DIN 223

TOL 6g



D Ø x P (mm)	Ø Exterior x Ø Espesor Ø Exterior x Ø Thickness (mm)	Cod.	€/Unid.	D Ø x P (mm)	Ø Exterior x Ø Espesor Ø Exterior x Ø Thickness (mm)	Cod.	€/Unid.
M 3 x 0.50	20 x 5	4R27426BL	25,82	M 8 x 1.25	25 x 9	4R27442BL	25,82
M 4 x 0.70	20 x 5	4R27430BL	25,82	M 10 x 1.50	30 x 11	4R27446BL	30,39
M 5 x 0.80	20 x 7	4R27434BL	25,82	M 12 x 1.75	38 x 14	4R27450BL	34,94
M 6 x 1.00	20 x 7	4R27438BL	25,82				

# M MÉTRICA ISO-ROSCA DIN 13 - BLISTER NEW

METRIC ISO-THREAD DIN 13 - BLISTER  
MÉTRIQUE DIN-13 - BLISTER



HSS-CO 5%

DIN 371

FORM C

TOL 6H

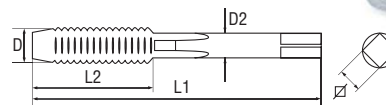

D Ø x P (mm)	L1 (mm)	L2 (mm)	D2 (mm)	∅ (mm)	Cod.	€/Unid.
M 3 x 0.50	56	11	3.5	2.7	3R37426BL	13,17
M 4 x 0.70	63	13	4.5	3.4	3R37430BL	13,40
M 5 x 0.80	70	16	6.0	4.9	3R37434BL	13,58
M 6 x 1.00	80	19	6.0	4.9	3R37438BL	14,00
M 8 x 1.25	90	22	8.0	6.2	3R37442BL	17,31
M 10 x 1.50	100	24	10.0	8.0	3R37446BL	19,80



HSS-CO 5%

DIN 376

FORM C

TOL 6H

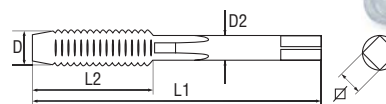

D Ø x P (mm)	L1 (mm)	L2 (mm)	D2 (mm)	∅ (mm)	Cod.	€/Unid.
M 12 x 1.75	110	29	9.0	7.0	3R38450BL	24,20



**M** MÉTRICA ISO-ROSCA DIN 13 - BLISTER **NEW**  
 METRIC ISO-THREAD DIN 13 - BLISTER  
 MÉTRIQUE DIN-13 - BLISTER



HSS-CO 5%

DIN 371

FORM B

TOL 6H

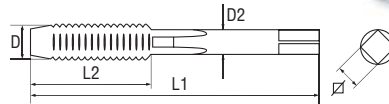

D Ø x P (mm)	L1 (mm)	L2 (mm)	D2 (mm)	∅ (mm)	Cod.	€/Unid.
M 3 x 0.50	56	11	3.5	2.7	3R37526BL	13,82
M 4 x 0.70	63	13	4.5	3.4	3R37530BL	13,77
M 5 x 0.80	70	16	6.0	4.9	3R37534BL	14,32
M 6 x 1.00	80	19	6.0	4.9	3R37538BL	15,00
M 8 x 1.25	90	22	8.0	6.2	3R37542BL	17,34
M 10 x 1.5	100	24	10.0	8.0	3R37546BL	20,85



HSS-CO 5%

DIN 376

FORM B

TOL 6H

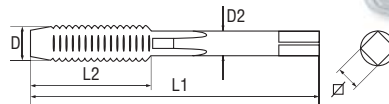

D Ø x P (mm)	L1 (mm)	L2 (mm)	D2 (mm)	∅ (mm)	Cod.	€/Unid.
M 12 x 1.75	110	29	9.0	7.0	3R38550BL	27,93

**M** MÉTRICA ISO-ROSCA DIN 13 - BLISTER **NEW**  
 METRIC ISO-THREAD DIN 13 - BLISTER  
 MÉTRIQUE DIN-13 - BLISTER



HSS-CO 5%

DIN 371

FORM C/35°

TOL 6H

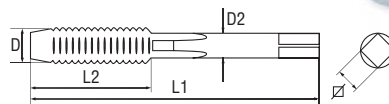

D Ø x P (mm)	L1 (mm)	L2 (mm)	D2 (mm)	∅ (mm)	Cod.	€/Unid.
M 3 x 0.5	56	6	3.5	2.7	3R37726BL	16,51
M 4 x 0.7	63	7	4.5	3.4	3R37730BL	16,51
M 5 x 0.8	70	8	6.0	4.9	3R37734BL	17,32
M 6 x 1.0	80	10	6.0	4.9	3R37738BL	17,32
M 8 x 1.25	90	14	8.0	6.2	3R37742BL	20,97
M 10 x 1.5	100	16	10.0	8.0	3R37746BL	24,49



HSS-CO 5%

DIN 376

FORM C/35°

TOL 6H

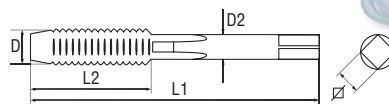

D Ø x P (mm)	L1 (mm)	L2 (mm)	D2 (mm)	∅ (mm)	Cod.	€/Unid.
M 12 x 1.75	110	18	9.0	7.0	3R38750BL	30,95

CONSTRUCCIÓN  
 CONSTRUCTION • CONSTRUCTION

MADERA  
 WOOD • BOIS

METAL  
 METAL • MÉTAL

FRESADO  
 MILLING • FRAISAGE

ROSCADO  
 THREADING • FILETAGE

ACCESORIOS  
 ACCESSORIES • ACCESSOIRES

HEXAGONAL  
 HEXAGONAL • HEXAGONAL

METROLOGÍA  
 METROLOGY • MÉTROLOGIE

DISPLAYS  
 DISPLAYS • DISPLAYS

# M JUEGOS DE MACHOS MÉTRICA ISO- ROSCA DIN 13

METRIC ISO-THREAD DIN 13 HAND TAPS  
 JEUX DE TARAUDS À MAIN, METRIQUE DIN 13

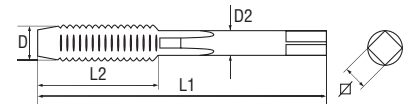
**HSS-G**
**DIN 352**
**TOL 6H**

D Ø x P (mm)	L1 (mm)	L2 (mm)	D2 (mm)	∅ (mm)	Cod.	€/Unid.	€/Set
M 1,00 x 0,25	32	5,5	2,5	2,1	2R27302	22,38	67,14
M 1,10 x 0,25	32	5,5	2,5	2,1	2R27304	22,38	67,14
M 1,20 x 0,25	32	5,5	2,5	2,1	2R27306	22,38	67,14
M 1,40 x 0,30	32	7,0	2,5	2,1	2R27308	22,38	67,14
M 1,60 x 0,35	32	8,0	2,5	2,1	2R27310	22,38	67,14
M 1,70 x 0,35	32	8,0	2,5	2,1	2R27312	22,38	67,14
M 1,80 x 0,35	32	8,0	2,5	2,1	2R27314	22,38	67,14
M 2,00 x 0,40	36	8,0	2,8	2,1	2R27316	9,15	27,45
M 2,20 x 0,45	36	9,0	2,8	2,1	2R27318	9,15	27,45
M 2,30 x 0,40	36	9,0	2,8	2,1	2R27320	9,15	27,45
M 2,50 x 0,45	40	9,0	2,8	2,1	2R27322	9,15	27,45
M 2,60 x 0,45	40	9,0	2,8	2,1	2R27324	9,15	27,45
M 3,00 x 0,50	40	11,0	3,5	2,7	2R27326	5,85	17,56
M 3,50 x 0,60	45	13,0	4,0	3,0	2R27328	7,61	22,83
M 4,00 x 0,70	45	13,0	4,5	3,4	2R27330	5,57	16,70
M 4,50 x 0,75	50	16,0	6,0	4,9	2R27332	8,54	25,61
M 5,00 x 0,80	50	16,0	6,0	4,9	2R27334	5,85	17,56
M 5,50 x 0,90	50	18,0	6,0	4,9	2R27336	13,84	41,52
M 6,00 x 1,00	50	19,0	6,0	4,9	2R27338	5,85	17,56
M 7,00 x 1,00	50	19,0	6,0	4,9	2R27340	8,72	26,16
M 8,00 x 1,25	56	22,0	6,0	4,9	2R27342	6,54	19,63
M 9,00 x 1,25	63	22,0	7,0	5,5	2R27344	11,60	34,79
M 10,00 x 1,50	70	24,0	7,0	5,5	2R27346	8,87	26,61
M 11,00 x 1,50	70	24,0	8,0	6,2	2R27348	15,25	45,75
M 12,00 x 1,75	75	29,0	9,0	7,0	2R27350	11,61	34,83
M 14,00 x 2,00	80	30,0	11,0	9,0	2R27354	13,39	40,17
M 15,00 x 2,00	80	32,0	12,0	9,0	2R27356	14,00	42,00
M 16,00 x 2,00	80	32,0	12,0	9,0	2R27358	18,85	56,56
M 18,00 x 2,50	95	40,0	14,0	11,0	2R27362	26,52	79,55
M 20,00 x 2,50	95	40,0	16,0	12,0	2R27366	28,27	84,80
M 22,00 x 2,50	100	40,0	18,0	14,5	2R27370	35,34	106,02
M 24,00 x 3,00	110	50,0	18,0	14,5	2R27374	47,12	141,37
M 27,00 x 3,00	110	50,0	20,0	16,0	2R27376	60,64	181,91
M 30,00 x 3,50	125	56,0	22,0	18,0	2R27378	81,61	244,84
M 33,00 x 3,50	125	56,0	25,0	20,0	2R27380	110,98	332,94
M 36,00 x 4,00	150	63,0	28,0	22,0	2R27382	139,32	417,95
M 39,00 x 4,00	150	63,0	32,0	24,0	2R27384	175,45	526,35
M 42,00 x 4,50	150	63,0	32,0	24,0	2R27386	196,23	588,68
M 45,00 x 4,50	160	70,0	36,0	29,0	2R27388	229,38	688,13
M 48,00 x 5,00	180	75,0	36,0	36,0	2R27390	311,12	933,37
M 52,00 x 5,00	180	75,0	40,0	32,0	2R27392	337,05	1.011,15
M 56,00 x 5,50	200	85,0	45,0	35,0	2R27394	427,08	1.281,25
M 60,00 x 5,50	200	85,0	45,0	35,0	2R27396	581,76	1.745,27
M 64,00 x 6,00	220	90,0	50,0	39,0	2R27398	706,51	2.119,52
M 68,00 x 6,00	220	90,0	50,0	39,0	2R27399	828,15	2.484,46

**M** JUEGOS DE MACHOS MÉTRICA ISO- ROSCA DIN 13 CON ENTRADA CÓNICA  
METRIC ISO-THREAD DIN 13 HAND TAPS  
JEUX DE TARAUDS À MAIN, METRIQUE DIN 13

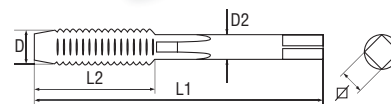

HSS-G

DIN 352

TOL 6H

D Ø x P (mm)	L1 (mm)	L2 (mm)	D2 (mm)	∅ (mm)	Cod.	€/Unid.	€/Set
M 2,00 x 0,40	36	8	2,8	2,1	2R27616	9,08	27,25
M 2,50 x 0,45	40	9	2,8	2,1	2R27622	9,08	27,25
M 3,00 x 0,50	40	11	3,5	2,7	2R27626	6,26	18,77
M 4,00 x 0,70	45	13	4,5	3,4	2R27630	5,95	17,85
M 5,00 x 0,80	50	16	6,0	4,9	2R27634	6,26	18,77
M 6,00 X 100	50	19	6,0	4,9	2R27638	6,26	18,77
M 8,00 x 1,25	56	22	6,0	4,9	2R27642	7,00	20,99
M 9,00 x 1,25	63	22	7,0	5,5	2R27644	11,86	35,58
M 10,00 x 1,50	70	24	7,0	5,5	2R27646	9,48	28,45
M 11,00 x 1,50	70	24	8,0	6,2	2R27648	15,14	45,42
M 12,00 x 1,75	75	29	9,0	7,0	2R27650	12,42	37,25
M 13,00 x 1,75	75	29	9,0	7,0	2R27652	17,09	51,26
M 14,00 x 2,00	80	30	11,0	9,0	2R27654	14,31	42,94
M 16,00 x 2,00	80	32	12,0	9,0	2R27658	20,15	60,46
M 18,00 x 2,50	95	40	14,0	11,0	2R27662	27,12	81,36
M 19,00 x 2,50	95	40	14,0	11,0	2R27664	37,42	112,26
M 20,00 x 2,50	95	40	16,0	12,0	2R27666	28,90	86,71
M 22,00 x 2,50	100	40	18,0	14,5	2R27670	36,14	108,42
M 24,00 x 3,00	110	50	18,0	14,5	2R27674	48,19	144,57
M 27,00 x 3,00	110	50	20,0	16,0	2R27676	60,58	181,73
M 30,00 x 3,50	125	56	22,0	18,0	2R27678	81,53	244,60
M 33,00 x 3,50	125	56	25,0	20,0	2R27680	107,65	322,94
M 36,00 x 4,00	150	63	28,0	22,0	2R27682	135,13	405,40
M 39,00 x 4,00	150	63	32,0	24,0	2R27684	156,43	469,29
M 42,00 x 4,50	150	63	32,0	24,0	2R27686	187,87	563,62
M 3,00 x 0,60	40	11	3,5	2,7	2R27627*	11,75	35,25
M 4,00 x 0,75	45	13	4,5	3,4	2R27631*	11,75	35,26

\*Hasta fin de existencias / \*Until end of stock / \*Jusqu'à épuisement des stocks

CONSTRUCCIÓN  
CONSTRUCTION • CONSTRUCTION

MADERA  
WOOD • BOIS

METAL  
METAL • MÉTAL

FRESADO  
MILLING • FRAISAGE

ROSCADO  
THREADING • FILETAGE

ACCESORIOS  
ACCESSORIES • ACCESSOIRES

HEXAGONAL  
HEXAGONAL • HEXAGONAL

METROLOGÍA  
METROLOGY • MÉTROLOGIE

DISPLAYS  
DISPLAYS • DISPLAYS

# Mf

## JUEGOS DE MACHOS MÉTRICA FINA DIN 13

METRIC FINE THREAD DIN 13 HAND TAPS  
 JEUX DE TARAUDS MÉTRIQUE FINE DIN 13

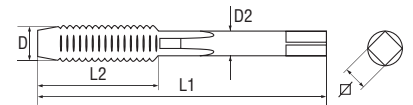

D Ø x P (mm)	L1 (mm)	L2 (mm)	D2 (mm)	∅ (mm)	Cod.	€/Unid.	€/Set
M 2,50 x 0,35	40	9	2,8	2,1	2R26304	16,84	33,67
M 2,60 x 0,35	40	9	2,8	2,1	2R26305	16,84	33,67
M 3,00 x 0,35	40	9	3,5	2,7	2R26308	16,84	33,67
M 3,50 x 0,35	45	10	4,0	3,0	2R26309	16,84	33,67
M 4,00 x 0,35	45	10	4,5	3,4	2R26310	16,84	33,67
M 4,00 x 0,50	45	10	4,5	3,4	2R26312	16,84	33,67
M 4,50 x 0,50	50	12	6,0	4,9	2R26313	16,84	33,67
M 5,00 x 0,50	50	12	6,0	4,9	2R26314	16,84	33,67
M 5,00 x 0,75	50	12	6,0	4,9	2R26316	16,84	33,67
M 5,50 x 0,50	50	12	6,0	4,9	2R26315	16,84	33,68
M 6,00 x 0,50	50	14	6,0	4,9	2R26317	13,35	26,70
M 6,00 x 0,75	50	14	6,0	4,9	2R26318	11,12	22,25
M 7,00 x 0,50	50	14	6,0	4,9	2R26319	15,24	30,47
M 7,00 x 0,75	50	14	6,0	4,9	2R26320	13,48	26,97
M 8,00 x 0,50	50	19	6,0	4,9	2R26322	19,91	39,82
M 8,00 x 0,75	50	19	6,0	4,9	2R26324	14,58	29,17
M 8,00 x 1,00	56	22	6,0	4,9	2R26326	11,36	22,72
M 9,00 x 0,50	56	19	7,0	5,5	2R26327	16,84	33,67
M 9,00 x 0,75	56	19	7,0	5,5	2R26328	16,84	33,67
M 9,00 x 1,00	63	20	7,0	5,5	2R26330	14,22	28,44
M 10,00 x 0,50	63	20	7,0	5,5	2R26331	19,91	39,82
M 10,00 x 0,75	63	20	7,0	5,5	2R26332	19,91	39,82
M 10,00 x 1,00	63	20	7,0	5,5	2R26336	11,17	22,34
M 10,00 x 1,25	70	24	7,0	5,5	2R26338	13,40	26,80
M 11,00 x 0,75	63	20	8,0	6,2	2R26339	26,79	53,57
M 11,00 x 1,00	63	20	8,0	6,2	2R26340	20,66	41,33
M 11,00 x 1,25	63	22	8,0	6,2	2R26342	20,66	41,33
M 12,00 x 0,50	70	22	9,0	7,0	2R26345	26,79	53,57
M 12,00 x 0,75	70	22	9,0	7,0	2R26343	26,79	53,57
M 12,00 x 1,00	70	22	9,0	7,0	2R26344	19,68	39,36
M 12,00 x 1,25	70	22	9,0	7,0	2R26346	19,68	39,36
M 12,00 x 1,50	70	22	9,0	7,0	2R26348	17,35	34,71
M 13,00 x 0,50	70	22	11,0	9,0	2R26347	30,61	61,22
M 13,00 x 0,75	70	22	11,0	9,0	2R26349	29,15	58,30
M 13,00 x 1,00	70	22	11,0	9,0	2R26350	30,61	61,22
M 13,00 x 1,50	70	22	11,0	9,0	2R26351	30,61	61,22
M 14,00 x 0,50	70	22	11,0	9,0	2R26355	34,44	68,88
M 14,00 x 0,75	70	22	11,0	9,0	2R26352	34,44	68,88
M 14,00 x 1,00	70	22	11,0	9,0	2R26353	29,15	58,30
M 14,00 x 1,25	70	22	11,0	9,0	2R26354	25,51	51,02
M 14,00 x 1,50	70	22	11,0	9,0	2R26356	19,05	38,10
M 15,00 x 0,75	70	22	12,0	9,0	2R26357	37,88	75,77
M 15,00 x 1,00	70	22	12,0	9,0	2R26358	37,88	75,77
M 15,00 x 1,50	70	22	12,0	9,0	2R26360	37,88	75,77
M 16,00 x 0,50	70	22	12,0	9,0	2R26361	34,82	69,64



**Mf** JUEGOS DE MACHOS MÉTRICA FINA DIN 13  
METRIC FINE THREAD DIN 13 HAND TAPS  
JEUX DE TARAUDS MÉTRIQUE FINE DIN 13

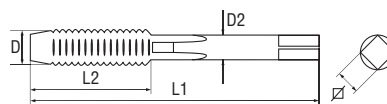

HSS-G

DIN 2181

TOL 6H

D Ø x P (mm)	L1 (mm)	L2 (mm)	D2 (mm)	∅ (mm)	Cod.	€/Unid.	€/Set
M 16,00 x 0,75	70	22	12,0	9,0	2R26363	34,82	69,64
M 16,00 x 1,00	70	22	12,0	9,0	2R26362	33,16	66,33
M 16,00 x 1,25	70	22	12,0	9,0	2R26364	33,16	66,33
M 16,00 x 1,50	70	22	12,0	9,0	2R26366	23,16	46,33
M 17,00 x 1,00	70	22	12,0	9,0	2R26368	37,88	75,77
M 17,00 x 1,50	70	22	12,0	9,0	2R26369	37,88	75,77
M 18,00 x 0,50	80	22	14,0	11,0	2R26367	37,88	75,77
M 18,00 x 0,75	80	22	14,0	11,0	2R26373	37,88	75,77
M 18,00 x 1,00	80	22	14,0	11,0	2R26370	36,08	72,16
M 18,00 x 1,25	80	22	14,0	11,0	2R26371	37,88	75,77
M 18,00 x 1,50	80	22	14,0	11,0	2R26372	31,58	63,17
M 18,00 x 2,00	80	22	14,0	11,0	2R26374	36,08	72,16
M 19,00 x 1,00	80	22	16,0	12,0	2R26375	49,75	99,50
M 19,00 x 1,50	80	22	14,0	11,0	2R26376	49,75	99,50
M 20,00 x 0,50	80	22	16,0	12,0	2R26377	49,75	99,50
M 20,00 x 0,75	80	22	16,0	12,0	2R26379	49,75	99,50
M 20,00 x 1,00	80	22	16,0	12,0	2R26378	49,75	99,50
M 20,00 x 1,25	80	22	16,0	12,0	2R26380	49,75	99,50
M 20,00 x 1,50	80	22	16,0	12,0	2R26384	38,70	77,40
M 20,00 x 2,00	80	22	16,0	12,0	2R26386	47,38	94,76
M 21,00 x 1,00	80	22	16,0	12,0	2R26387	49,75	99,50
M 21,00 x 1,50	80	22	16,0	12,0	2R26388	49,75	99,50
M 22,00 x 0,50	80	22	18,0	14,5	2R26389	49,75	99,50
M 22,00 x 0,75	80	22	18,0	14,5	2R26391	49,75	99,50
M 22,00 x 1,00	80	22	18,0	14,5	2R26390	49,75	99,50
M 22,00 x 1,25	80	22	18,0	14,5	2R26392	49,75	99,50
M 22,00 x 1,50	80	22	18,0	14,5	2R26394	45,20	90,39
M 22,00 x 2,00	80	22	18,0	14,5	2R26396	47,38	94,76
M 23,00 x 1,00	80	22	18,0	14,5	2R26397	68,89	137,78
M 23,00 x 1,50	80	22	18,0	14,5	2R26398	68,89	137,77
M 24,00 x 0,50	90	22	18,0	14,5	2R26501	68,89	137,78
M 24,00 x 0,75	90	22	18,0	14,5	2R26503	68,89	137,78
M 24,00 x 1,00	90	22	18,0	14,5	2R26500	68,89	137,77
M 24,00 x 1,25	90	22	18,0	14,5	2R26502	68,89	137,77
M 24,00 x 1,50	90	22	18,0	14,5	2R26504	59,93	119,87
M 24,00 x 2,00	90	22	18,0	14,5	2R26506	65,61	131,21
M 25,00 x 1,00	90	22	18,0	14,5	2R26507	99,50	198,99
M 25,00 x 1,50	90	22	18,0	14,5	2R26508	95,67	191,34
M 26,00 x 1,00	90	22	18,0	14,5	2R26510	95,67	191,34
M 26,00 x 1,50	90	22	18,0	14,5	2R26512	85,38	170,76
M 26,00 x 2,00	90	22	18,0	14,5	2R26514	94,76	189,52
M 27,00 x 1,00	90	22	20,0	16,0	2R26516	99,50	198,99
M 27,00 x 1,50	90	22	20,0	16,0	2R26517	99,50	198,99
M 27,00 x 2,00	90	22	20,0	16,0	2R26518	113,27	226,54
M 28,00 x 1,00	90	22	20,0	16,0	2R26520	122,45	244,90

CONSTRUCCIÓN  
CONSTRUCTION • CONSTRUCTION

MADERA  
WOOD • BOIS

METAL  
METAL • MÉTAL

FRESADO  
MILLING • FRAISAGE

ROSCADO  
THREADING • FILETAGE

ACCESORIOS  
ACCESSORIES • ACCESSOIRES

HEXAGONAL  
HEXAGONAL • HEXAGONAL

METROLOGÍA  
METROLOGY • MÉTROLOGIE

DISPLAYS  
DISPLAYS • DISPLAYS

# Mf

JUEGOS DE MACHOS MÉTRICA FINA DIN 13  
 METRIC FINE THREAD DIN 13 HAND TAPS  
 JEUX DE TARAUDS MÉTRIQUE FINE DIN 13

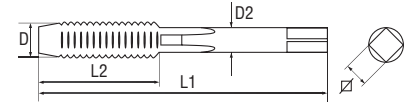
**HSS-G**
**DIN 2181**
**TOL 6H**

D Ø x P (mm)	L1 (mm)	L2 (mm)	D2 (mm)	∅ (mm)	Cod.	€/Unid.	€/Set
M 28,00 x 1,50	90	22	20,0	16,0	2R26522	103,31	<b>206,63</b>
M 28,00 x 2,00	90	22	20,0	16,0	2R26524	114,80	<b>229,60</b>
M 29,00 x 1,50	90	22	22,0	18,0	2R26526	118,63	<b>237,25</b>
M 30,00 x 1,00	90	22	22,0	18,0	2R26528	119,39	<b>238,78</b>
M 30,00 x 1,50	90	22	22,0	18,0	2R26530	107,91	<b>215,82</b>
M 30,00 x 2,00	90	22	22,0	18,0	2R26532	122,45	<b>244,90</b>
M 30,00 x 2,50	125	56	22,0	18,0	2R26533	122,45	<b>244,90</b>
M 30,00 x 3,00	125	56	22,0	18,0	2R26534	130,11	<b>260,22</b>
M 32,00 x 1,00	90	22	22,0	18,0	2R26539	130,11	<b>260,22</b>
M 32,00 x 1,50	90	22	22,0	18,0	2R26536	130,11	<b>260,22</b>
M 32,00 x 2,00	90	22	22,0	18,0	2R26535	130,11	<b>260,22</b>
M 32,00 x 3,00	125	56	22,0	18,0	2R26537	130,11	<b>260,22</b>
M 33,00 x 1,50	100	25	25,0	20,0	2R26538	130,11	<b>260,22</b>
M 33,00 x 2,00	100	25	25,0	20,0	2R26540	160,72	<b>321,44</b>
M 33,00 x 3,00	125	56	25,0	20,0	2R26542	160,72	<b>321,44</b>
M 34,00 x 1,00	100	25	28,0	22,0	2R26543	160,72	<b>321,45</b>
M 34,00 x 1,50	100	25	28,0	22,0	2R26544	160,72	<b>321,44</b>
M 34,00 x 2,00	125	40	28,0	22,0	2R26546	168,38	<b>336,76</b>
M 35,00 x 1,00	100	25	28,0	22,0	2R26547	160,72	<b>321,44</b>
M 35,00 x 1,50	100	25	28,0	22,0	2R26548	160,72	<b>321,44</b>
M 35,00 x 2,00	125	40	28,0	22,0	2R26549	160,72	<b>321,44</b>
M 36,00 x 1,00	100	25	28,0	22,0	2R26551	171,43	<b>342,87</b>
M 36,00 x 1,50	100	25	28,0	22,0	2R26550	171,43	<b>342,87</b>
M 36,00 x 2,00	125	40	28,0	22,0	2R26552	176,03	<b>352,06</b>
M 36,00 x 3,00	125	40	28,0	22,0	2R26554	176,03	<b>352,06</b>
M 37,00 x 1,50	100	25	28,0	22,0	2R26553	198,99	<b>397,98</b>
M 38,00 x 1,00	100	25	28,0	22,0	2R26555	198,99	<b>397,98</b>
M 38,00 x 1,50	100	25	28,0	22,0	2R26556	198,99	<b>397,98</b>
M 38,00 x 2,00	125	40	28,0	22,0	2R26557	214,30	<b>428,59</b>
M 38,00 x 3,00	125	40	28,0	22,0	2R26559	214,29	<b>428,59</b>
M 39,00 x 1,50	110	25	32,0	24,0	2R26558	214,30	<b>428,59</b>
M 39,00 x 2,00	125	40	32,0	24,0	2R26560	214,30	<b>428,59</b>
M 39,00 x 3,00	125	40	32,0	24,0	2R26562	214,30	<b>428,59</b>
M 40,00 x 1,00	110	25	32,0	24,0	2R26563	214,29	<b>428,59</b>
M 40,00 x 1,50	110	25	32,0	24,0	2R26564	214,30	<b>428,59</b>
M 40,00 x 2,00	125	40	32,0	24,0	2R26566	214,30	<b>428,59</b>
M 40,00 x 3,00	125	40	32,0	24,0	2R26568	229,60	<b>459,21</b>
M 42,00 x 1,00	110	25	32,0	24,0	2R26569	229,60	<b>459,20</b>
M 42,00 x 1,50	110	25	32,0	24,0	2R26570	229,60	<b>459,21</b>
M 42,00 x 2,00	125	40	32,0	24,0	2R26572	229,60	<b>459,21</b>
M 42,00 x 3,00	125	40	32,0	24,0	2R26574	260,22	<b>520,44</b>
M 44,00 x 1,50	110	25	36,0	29,0	2R26571	267,87	<b>535,73</b>
M 44,00 x 2,00	125	40	36,0	29,0	2R26573	267,87	<b>535,74</b>
M 45,00 x 1,00	110	25	36,0	29,0	2R26575	267,87	<b>535,73</b>
M 45,00 x 1,50	110	25	36,0	29,0	2R26576	267,87	<b>535,74</b>

# Mf

JUEGOS DE MACHOS MÉTRICA FINA DIN 13  
METRIC FINE THREAD DIN 13 HAND TAPS  
JEUX DE TARAUDS MÉTRIQUE FINE DIN 13

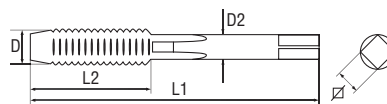

HSS-G

DIN 2181

TOL 6H

D Ø x P (mm)	L1 (mm)	L2 (mm)	D2 (mm)	∅ (mm)	Cod.	€/Unid.	€/Set
M 45,00 x 2,00	125	40	36,0	29,0	2R26578	267,87	535,74
M 45,00 x 3,00	125	40	36,0	29,0	2R26580	267,87	535,74
M 46,00 x 1,50	140	40	36,0	29,0	2R26581	267,87	535,73
M 48,00 x 1,00	140	40	36,0	29,0	2R26583	290,83	581,65
M 48,00 x 1,50	140	40	36,0	29,0	2R26582	290,83	581,66
M 48,00 x 2,00	140	40	36,0	29,0	2R26584	290,83	581,66
M 48,00 x 3,00	140	40	36,0	29,0	2R26586	290,83	581,66
M 50,00 x 1,50	140	40	36,0	29,0	2R26588	325,27	650,53
M 50,00 x 2,00	140	40	36,0	29,0	2R26590	325,27	650,53
M 50,00 x 3,00	140	40	36,0	29,0	2R26592	325,27	650,53
M 52,00 x 1,50	140	40	40,0	32,0	2R26594	355,88	711,76
M 52,00 x 2,00	140	40	40,0	32,0	2R26596	382,67	765,34
M 52,00 x 3,00	140	40	40,0	32,0	2R26598	382,67	765,34
M 54,00 x 1,00	140	32	40,0	32,0	2R28118	416,17	832,34
M 54,00 x 1,50	140	32	40,0	32,0	2R28001	417,94	835,88
M 54,00 x 2,00	140	36	40,0	32,0	2R28002	417,94	835,89
M 54,00 x 3,00	140	40	40,0	32,0	2R28003	417,94	835,88
M 54,00 x 4,00	180	50	40,0	32,0	2R28004	417,94	835,88
M 55,00 x 1,50	140	32	40,0	32,0	2R28005	549,31	1.098,62
M 55,00 x 2,00	140	36	40,0	32,0	2R28006	549,31	1.098,61
M 55,00 x 3,00	140	40	40,0	32,0	2R28007	549,31	1.098,62
M 55,00 x 4,00	180	50	40,0	32,0	2R28008	549,31	1.098,62
M 56,00 x 1,00	140	32	40,0	32,0	2R28119	583,64	1.167,27
M 56,00 x 1,50	140	32	40,0	32,0	2R28009	583,64	1.167,27
M 56,00 x 2,00	140	36	40,0	32,0	2R28010	582,79	1.165,58
M 56,00 x 3,00	140	40	40,0	32,0	2R28011	582,79	1.165,58
M 56,00 x 4,00	180	50	40,0	32,0	2R28012	506,77	1.013,55
M 58,00 x 1,00	160	32	45,0	35,0	2R28120	617,97	1.235,94
M 58,00 x 1,50	160	32	45,0	35,0	2R28013	617,97	1.235,94
M 58,00 x 2,00	160	36	45,0	35,0	2R28014	617,97	1.235,94
M 58,00 x 3,00	160	40	45,0	35,0	2R28015	617,97	1.235,94
M 58,00 x 4,00	200	55	45,0	35,0	2R28016	617,97	1.235,94
M 60,00 x 1,50	160	34	45,0	35,0	2R28017	635,13	1.270,26
M 60,00 x 2,00	160	36	45,0	35,0	2R28018	635,13	1.270,26
M 60,00 x 3,00	160	40	45,0	35,0	2R28019	635,13	1.270,26
M 60,00 x 4,00	200	55	45,0	35,0	2R28020	635,13	1.270,26
M 62,00 x 1,50	160	34	50,0	39,0	2R28021	686,63	1.373,26
M 62,00 x 2,00	160	36	50,0	39,0	2R28022	686,63	1.373,26
M 62,00 x 3,00	180	45	50,0	39,0	2R28023	686,52	1.373,05
M 62,00 x 4,00	220	55	50,0	39,0	2R28024	686,63	1.373,26
M 63,00 x 1,50	160	32	50,0	39,0	2R28025	703,80	1.407,61
M 64,00 x 1,50	160	34	50,0	39,0	2R28026	703,80	1.407,61
M 64,00 x 2,00	160	36	50,0	39,0	2R28027	703,80	1.407,61
M 64,00 x 3,00	180	45	50,0	39,0	2R28028	703,80	1.407,61
M 64,00 x 4,00	220	60	50,0	39,0	2R28029	703,80	1.407,61

CONSTRUCCIÓN  
CONSTRUCTION • CONSTRUCTION

MADERA  
WOOD • BOIS

METAL  
METAL • MÉTAL

FRESADO  
MILLING • FRAISAGE

ROSCADO  
THREADING • FILETAGE

ACCESORIOS  
ACCESSORIES • ACCESSOIRES

HEXAGONAL  
HEXAGONAL • HEXAGONAL

METROLOGÍA  
METROLOGY • MÉTROLOGIE

DISPLAYS  
DISPLAYS • DISPLAYS

# Mf

## JUEGOS DE MACHOS MÉTRICA FINA DIN 13

METRIC FINE THREAD DIN 13 HAND TAPS  
 JEUX DE TARAUDS MÉTRIQUE FINE DIN 13

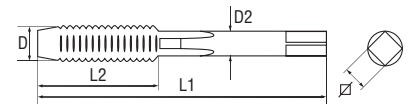
**HSS-G**
**DIN 2181**
**TOL 6H**

D Ø x P (mm)	L1 (mm)	L2 (mm)	D2 (mm)	∅ (mm)	Cod.	€/Unid.	€/Set
M 65,00 x 1,50	160	34	50,0	39,0	2R28030	755,30	1.510,59
M 65,00 x 2,00	160	36	50,0	39,0	2R28031	755,30	1.510,59
M 65,00 x 3,00	180	45	50,0	39,0	2R28032	755,30	1.510,59
M 65,00 x 4,00	220	60	50,0	39,0	2R28033	755,30	1.510,60
M 68,00 x 1,50	160	36	50,0	39,0	2R28034	772,47	1.544,94
M 68,00 x 2,00	160	40	50,0	39,0	2R28035	772,47	1.544,94
M 68,00 x 3,00	180	50	50,0	39,0	2R28036	772,47	1.544,94
M 68,00 x 4,00	220	60	50,0	39,0	2R28037	772,47	1.544,93
M 70,00 x 1,50	160	36	50,0	39,0	2R28038	1.243,50	2.487,00
M 70,00 x 2,00	160	40	50,0	39,0	2R28039	1.243,50	2.487,00
M 70,00 x 3,00	200	50	50,0	39,0	2R28040	1.414,48	2.828,96
M 70,00 x 4,00	240	60	50,0	39,0	2R28041	1.414,48	2.828,96
M 72,00 x 1,50	160	36	50,0	39,0	2R28042	1.243,50	2.487,00
M 72,00 x 2,00	160	40	50,0	39,0	2R28043	1.243,50	2.487,00
M 72,00 x 3,00	200	50	50,0	39,0	2R28044	1.414,48	2.828,96
M 72,00 x 4,00	240	60	50,0	39,0	2R28045	1.414,48	2.828,96
M 74,00 x 1,50	160	36	50,0	39,0	2R28046	1.367,85	2.735,70
M 74,00 x 2,00	160	40	50,0	39,0	2R28047	1.367,85	2.735,70
M 74,00 x 3,00	200	50	50,0	39,0	2R28048	1.616,55	3.233,11
M 74,00 x 4,00	240	60	50,0	39,0	2R28049	1.616,55	3.233,11
M 75,00 x 1,50	160	36	50,0	39,0	2R28050	1.392,72	2.785,45
M 75,00 x 2,00	160	40	50,0	39,0	2R28051	1.392,72	2.785,45
M 75,00 x 3,00	200	50	50,0	39,0	2R28052	1.647,64	3.295,28
M 75,00 x 4,00	240	60	50,0	39,0	2R28053	1.647,64	3.295,28
M 76,00 x 1,50	160	36	50,0	39,0	2R28054	1.414,48	2.828,96
M 76,00 x 2,00	160	40	50,0	39,0	2R28055	1.414,48	2.828,96
M 76,00 x 3,00	220	50	50,0	39,0	2R28056	1.740,90	3.481,80
M 76,00 x 4,00	260	60	50,0	39,0	2R28057	1.740,90	3.481,80
M 78,00 x 1,50	160	36	50,0	39,0	2R28058	1.414,48	2.828,96
M 78,00 x 2,00	160	40	50,0	39,0	2R28059	1.414,48	2.828,96
M 78,00 x 3,00	220	55	50,0	39,0	2R28060	1.735,60	3.471,20
M 78,00 x 4,00	260	65	50,0	39,0	2R28061	1.740,90	3.481,80
M 80,00 x 1,50	160	36	50,0	39,0	2R28062	1.538,83	3.077,67
M 80,00 x 2,00	160	40	50,0	39,0	2R28063	1.538,83	3.077,67
M 80,00 x 3,00	220	55	50,0	39,0	2R28064	1.911,88	3.823,76
M 80,00 x 4,00	260	65	50,0	39,0	2R28065	1.911,88	3.823,76
M 82,00 x 1,50	160	36	50,0	39,0	2R28066	1.538,83	3.077,67
M 82,00 x 2,00	160	40	50,0	39,0	2R28067	1.538,83	3.077,67
M 82,00 x 3,00	220	55	50,0	39,0	2R28068	1.911,88	3.823,76
M 82,00 x 4,00	260	65	50,0	39,0	2R28069	1.911,88	3.823,76
M 84,00 x 1,50	160	36	50,0	39,0	2R28070	1.787,53	3.575,06
M 84,00 x 2,00	160	40	50,0	39,0	2R28071	1.787,53	3.575,06
M 84,00 x 3,00	220	55	50,0	39,0	2R28072	2.176,13	4.352,25
M 84,00 x 4,00	260	65	50,0	39,0	2R28073	2.176,13	4.352,25
M 85,00 x 1,50	160	36	50,0	39,0	2R28074	2.331,57	4.663,13



**Mf** JUEGOS DE MACHOS MÉTRICA FINA DIN 13  
METRIC FINE THREAD DIN 13 HAND TAPS  
JEUX DE TARAUDS MÉTRIQUE FINE DIN 13

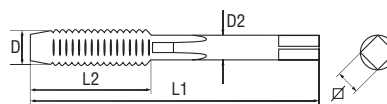

HSS-G

DIN 2181

TOL 6H

D Ø x P (mm)	L1 (mm)	L2 (mm)	D2 (mm)	∅ (mm)	Cod.	€/Unid.	€/Set
M 85,00 x 2,00	160	40	50,0	39,0	2R28075	2.331,57	<b>4.663,13</b>
M 85,00 x 3,00	220	55	50,0	39,0	2R28076	2.828,97	<b>5.657,93</b>
M 85,00 x 4,00	260	65	50,0	39,0	2R28077	2.828,97	<b>5.657,93</b>
M 86,00 x 1,50	160	36	50,0	39,0	2R28078	2.331,57	<b>4.663,13</b>
M 86,00 x 2,00	160	40	50,0	39,0	2R28079	2.331,57	<b>4.663,13</b>
M 86,00 x 3,00	220	55	50,0	39,0	2R28080	2.828,97	<b>5.657,93</b>
M 86,00 x 4,00	260	65	50,0	39,0	2R28081	2.828,97	<b>5.657,93</b>
M 88,00 x 1,50	160	38	50,0	39,0	2R28082	2.533,63	<b>5.067,27</b>
M 88,00 x 2,00	160	40	50,0	39,0	2R28083	2.533,63	<b>5.067,27</b>
M 88,00 x 3,00	220	55	50,0	39,0	2R28084	2.937,77	<b>5.875,54</b>
M 88,00 x 4,00	260	65	50,0	39,0	2R28085	2.937,77	<b>5.875,54</b>
M 90,00 x 1,50	160	38	50,0	39,0	2R28086	2.642,44	<b>5.284,88</b>
M 90,00 x 2,00	160	40	50,0	39,0	2R28087	2.642,44	<b>5.284,88</b>
M 90,00 x 3,00	220	55	50,0	39,0	2R28088	3.139,84	<b>6.279,67</b>
M 90,00 x 4,00	260	65	50,0	39,0	2R28089	3.139,84	<b>6.279,67</b>
M 92,00 x 1,50	180	40	56,0	44,0	2R28090	2.642,44	<b>5.284,88</b>
M 92,00 x 2,00	180	45	56,0	44,0	2R28091	2.642,44	<b>5.284,88</b>
M 92,00 x 3,00	240	60	56,0	44,0	2R28092	3.341,91	<b>6.683,82</b>
M 92,00 x 4,00	280	70	56,0	44,0	2R28093	3.341,91	<b>6.683,82</b>
M 95,00 x 1,50	180	40	56,0	44,0	2R28094	3.383,56	<b>6.767,12</b>
M 95,00 x 2,00	180	45	56,0	44,0	2R28095	3.383,56	<b>6.767,12</b>
M 95,00 x 3,00	240	60	56,0	44,0	2R28096	3.808,22	<b>7.616,45</b>
M 95,00 x 4,00	280	70	56,0	44,0	2R28097	3.808,22	<b>7.616,45</b>
M 96,00 x 1,50	180	40	56,0	44,0	2R28098	2.875,59	<b>5.751,19</b>
M 96,00 x 2,00	180	45	56,0	44,0	2R28099	2.875,59	<b>5.751,19</b>
M 96,00 x 3,00	240	60	56,0	44,0	2R28100	3.808,22	<b>7.616,45</b>
M 96,00 x 4,00	280	70	56,0	44,0	2R28101	3.808,22	<b>7.616,45</b>
M 98,00 x 1,50	180	40	56,0	44,0	2R28102	4.632,04	<b>9.264,08</b>
M 98,00 x 2,00	180	45	56,0	44,0	2R28103	4.632,04	<b>9.264,08</b>
M 98,00 x 3,00	240	60	56,0	44,0	2R28104	4.041,38	<b>8.082,75</b>
M 98,00 x 4,00	280	70	56,0	44,0	2R28105	4.041,38	<b>8.082,75</b>
M 100,00 x 1,50	180	45	56,0	44,0	2R28106	3.512,89	<b>7.025,78</b>
M 100,00 x 2,00	180	50	56,0	44,0	2R28107	3.512,89	<b>7.025,78</b>
M 100,00 x 3,00	240	65	56,0	44,0	2R28108	4.274,53	<b>8.549,06</b>
M 100,00 x 4,00	280	75	56,0	44,0	2R28109	4.274,53	<b>8.549,06</b>
M 105,00 x 1,50	180	45	56,0	44,0	2R28110	3.808,22	<b>7.616,45</b>
M 105,00 x 2,00	180	50	56,0	44,0	2R28111	3.808,22	<b>7.616,45</b>
M 105,00 x 3,00	240	65	56,0	44,0	2R28112	4.585,41	<b>9.170,82</b>
M 105,00 x 4,00	280	75	56,0	44,0	2R28113	4.585,41	<b>9.170,82</b>
M 110,00 x 1,50	180	45	56,0	44,0	2R28114	4.212,36	<b>8.424,71</b>
M 110,00 x 2,00	180	50	56,0	44,0	2R28115	4.212,36	<b>8.424,71</b>
M 110,00 x 3,00	240	65	56,0	44,0	2R28116	5.176,07	<b>10.352,14</b>
M 110,00 x 4,00	280	75	56,0	44,0	2R28117	5.176,07	<b>10.352,14</b>

CONSTRUCCIÓN  
CONSTRUCTION • CONSTRUCTION

MADERA  
WOOD • BOIS

METAL  
METAL • MÉTAL

FRESADO  
MILLING • FRAISAGE

ROSCADO  
THREADING • FILETAGE

ACCESORIOS  
ACCESSORIES • ACCESSOIRES

HEXAGONAL  
HEXAGONAL • HEXAGONAL

METROLOGÍA  
METROLOGY • MÉTROLOGIE

DISPLAYS  
DISPLAYS • DISPLAYS

# M

**MÉTRICA ISO-ROSCA DIN 13**  
 MÉTRIC ISO-THREAD DIN 13  
 MÉTRIQUE DIN-13

**HSS-G**
**DIN 223**
**TOL 6g**

D Ø x P (mm)	Ø Exterior x Ø Espesor Ø Exterior x Ø Thickness (mm)	Cod.	€/Unid.
M 1,0 x 0,25	16 x 5	4R27402	45,45
M 1,1 x 0,25	16 x 5	4R27404	45,45
M 1,2 x 0,25	16 x 5	4R27406	41,56
M 1,4 x 0,30	16 x 5	4R27408	41,56
M 1,6 x 0,35	16 x 5	4R27410	38,95
M 1,7 x 0,35	16 x 5	4R27412	38,96
M 1,8 x 0,35	16 x 5	4R27414	38,95
M 2,0 x 0,40	16 x 5	4R27416	28,57
M 2,2 x 0,45	16 x 5	4R27418	32,45
M 2,3 x 0,40	16 x 5	4R27420	32,45
M 2,5 x 0,45	16 x 5	4R27422	32,45
M 2,6 x 0,45	16 x 5	4R27424	32,45
M 3,0 x 0,50	20 x 5	4R27426	22,07
M 3,5 x 0,60	20 x 5	4R27428	22,07
M 4,0 x 0,70	20 x 5	4R27430	22,07
M 4,5 x 0,75	20 x 7	4R27432	22,07
M 5,0 x 0,80	20 x 7	4R27434	22,07
M 5,5 x 0,90	20 x 7	4R27436	22,07
M 6,0 x 1,00	20 x 7	4R27438	22,07
M 7,0 x 1,00	25 x 9	4R27440	22,07
M 8,0 x 1,25	25 x 9	4R27442	22,07
M 9,0 x 1,25	25 x 9	4R27444	22,07
M 10,0 x 1,50	30 x 11	4R27446	25,98

D Ø x P (mm)	Ø Exterior x Ø Espesor Ø Exterior x Ø Thickness (mm)	Cod.	€/Unid.
M 11 x 1,50	30 x 11	4R27448	25,98
M 12 x 1,75	38 x 14	4R27450	29,86
M 14 x 2,00	38 x 14	4R27454	29,86
M 15 x 2,00	38 x 14	4R27456	50,91
M 16 x 2,00	45 x 18	4R27458	43,05
M 18 x 2,50	45 x 18	4R27462	43,05
M 19 x 2,50	45 x 18	4R27464	43,05
M 20 x 2,50	45 x 18	4R27466	43,05
M 22 x 2,50	55 x 22	4R27470	74,97
M 24 x 3,00	55 x 22	4R27474	74,97
M 27 x 3,00	65 x 25	4R27476	108,04
M 30 x 3,50	65 x 25	4R27478	108,04
M 33 x 3,50	65 x 25	4R27480	108,04
M 36 x 4,00	65 x 25	4R27482	108,04
M 39 x 4,00	75 x 30	4R27484	168,79
M 42 x 4,50	75 x 30	4R27486	168,79
M 45 x 4,50	90 x 36	4R27488	279,17
M 48 x 5,00	90 x 36	4R27490	279,17
M 52 x 5,00	90 x 36	4R27492	279,17
M 56 x 5,50	105 x 36	4R27494	598,48
M 60 x 5,50	105 x 36	4R27496	598,49
M 64 x 6,00	120 x 36	4R27498	782,62
M 68 x 6,00	120 x 36	4R27499	782,62

DIN 223 = DIN EN 22568